

# instruction sheet **Holley® Carburetor Model 4010**

## TYPICAL VIEW

The exploded view shown is typical of the model carburetor this kit will service. The view may differ slightly from the actual carburetor being renewed.

This is a universal kit that may contain more parts than are actually required to service a given carburetor. When similar gaskets or parts are included in the kit, compare with original parts.

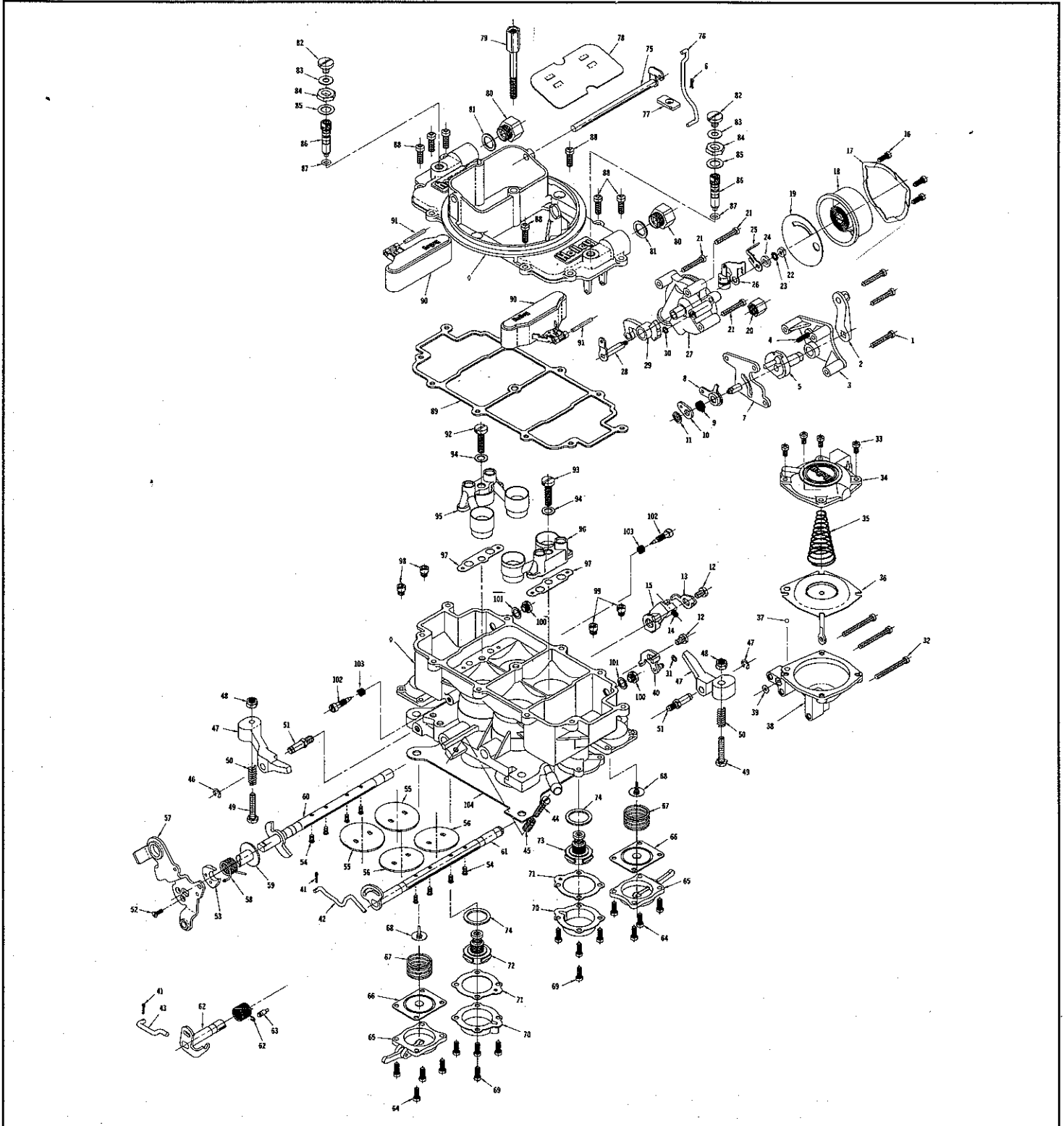

# CARBURETOR ADJUSTMENTS

## DISASSEMBLY

Rest the carburetor on a repair stand to avoid damage to the throttle plates during renew procedures. Use exploded view as a guide, and follow the numerical sequence in general to disassemble unit far enough to permit cleaning and inspection. Do not remove throttle plates or shaft. Observe and record the initial position of the needle slot. Turn the idle needles clockwise until lightly seated, recording the number of turns required to seat the needles. This procedure is necessary to reinstall the idle needles after renewing.

## CLEANING

Cleaning must be done with carburetor disassembled. Soak parts long enough to soften and remove all foreign material. Use a carburetor solvent, lacquer thinner or denatured alcohol. Make certain the throttle body is free of all hard carbon deposits. Wash off in suitable solvent. Blow out all passages in castings with compressed air and check carefully to insure thorough cleaning of obscure areas.

**CAUTION:** Do not soak parts containing rubber or plastic material. Serious damage could result.

## REASSEMBLY

Reassemble in reverse order of disassembly. Note special instructions and follow outline in making adjustments.

Manually operate the throttle lever and choke mechanism, checking for binding or malfunction. Any binding or interference could cause throttle to stick during operation and result in loss of carburetor throttle control (or uncontrolled engine speed).

Check carburetor to be sure there are no leaks, flooding, which might cause a fire.

## SPECIAL INSTRUCTIONS

**IDLE ADJUSTING NEEDLES** — Tapered portion of needle must be straight and smooth. If grooved or ridged, a new needle should be installed.

**PUMP INLET CHECK VALVE**—Lubricate tip of new valve and insert in center hole in pump cavity. Pull thru from fuel bowl side until seated.

**POWER VALVE COVER** — Stamped steel cover requires two gaskets. Die cast cover requires only one gasket. Improper gasket usage could result in fuel leakage. See figure 1.

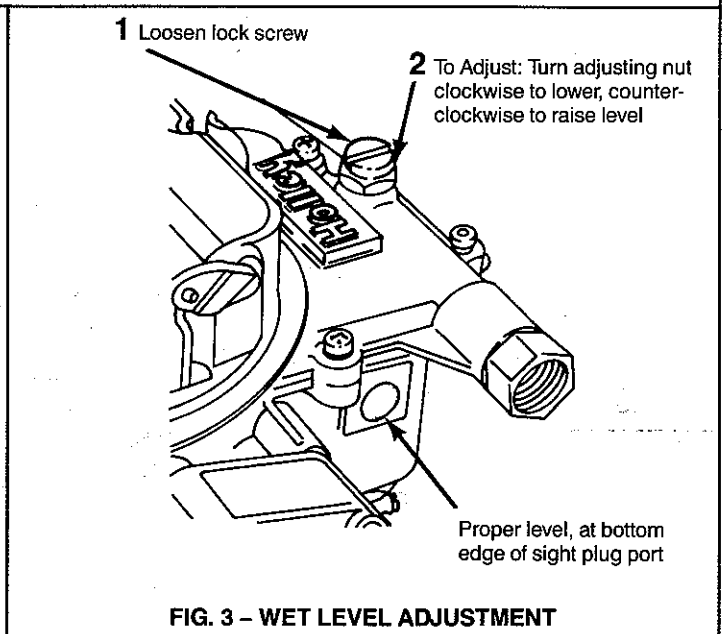
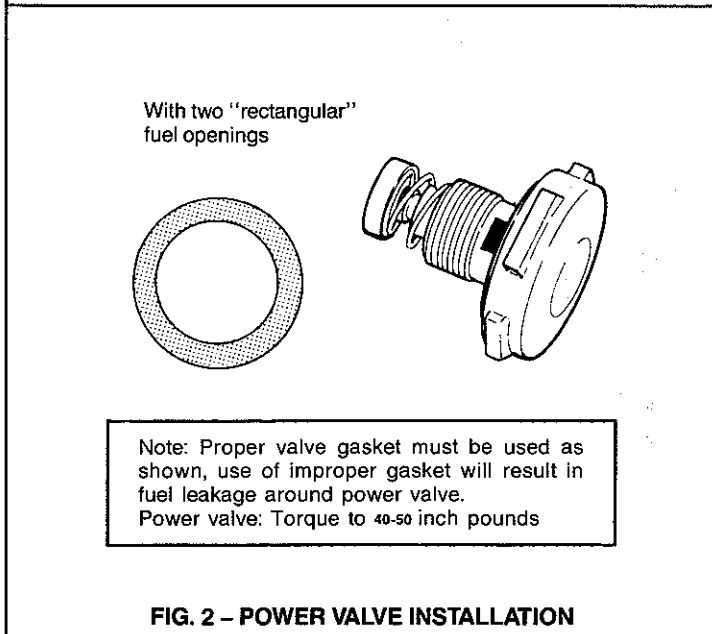
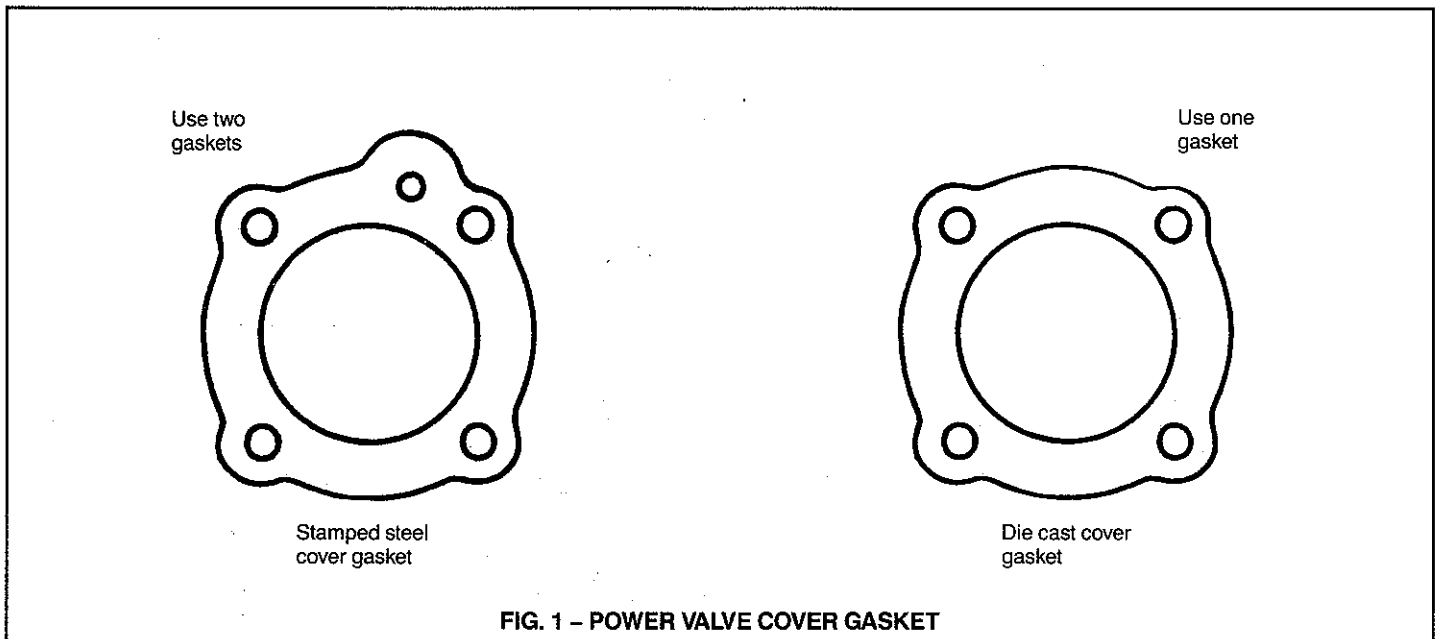

2 Choke lever in closed choke position

1 Push rod down

3 Top of choke rod 1/2 to 1 rod dia. below hole

4 To Adjust: Bend rod here

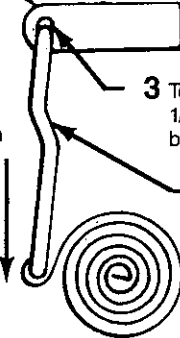

Type 1

FIG. 4 - CHOKE ROD ADJUSTMENT (AUTOMATIC CHOKE)

4 Measure the distance between the lower edge of the choke plate & airhorn wall

5 To Adjust: Bend throttle lever unloader tang

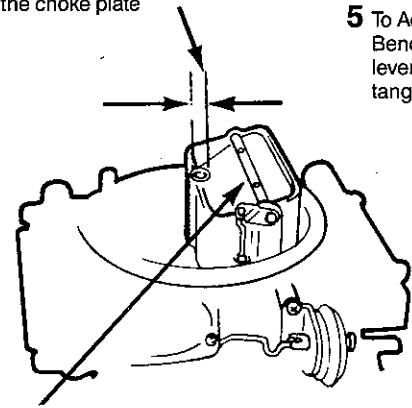

3 Light closing pressure on choke plate

2 Throttle plates in wide open position

1 Choke rod properly adjusted

FIG. 5 - UNLOADER ADJUSTMENT (AUTOMATIC CHOKE)

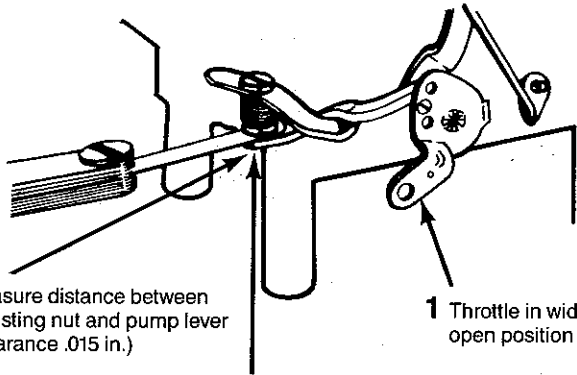

3 Measure distance between adjusting nut and pump lever (clearance .015 in.)

1 Throttle in wide open position

2 Pump operating lever fully compressed

FIG. 6 - PUMP OVERRIDE ADJUSTMENT

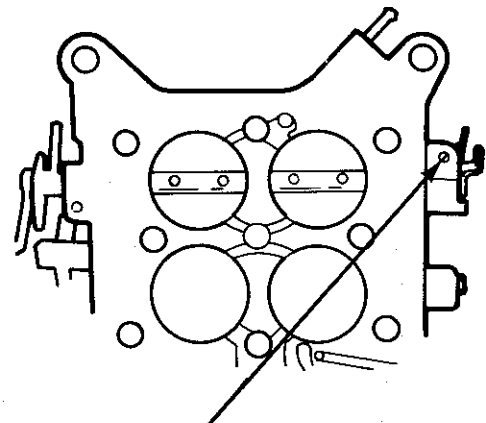

Back the secondary throttle stop screw out until the secondary throttle plates are closed in the throttle bore. Turn the screw in (clockwise) until it just touches the stop on the lever, then give it an additional 1/4 turn.

FIG. 7 - SECONDARY THROTTLE STOP ADJUSTMENT

NOTE: Bend a paper clip (.030 to .036 dia.) as shown to provide end no longer than 1/8 inch long.

1 Insert paper clip into piston bore until end of bore slot is hooked as shown

2 Move piston and levers in choke closing direction until edge of piston slot engages paper clip

3 Measure distance between lower edge of choke plate and airhorn. See Fig. 5

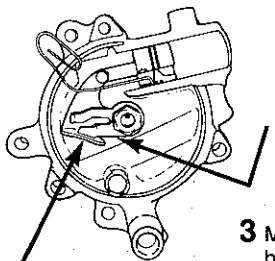

4 To Adjust: Bend piston lever tang

FIG. 8 - CHOKE QUALIFYING (INTEGRAL CHOKE) ADJUSTMENT

Rotate cover to align ref. mark on cover with specified mark on choke housing.

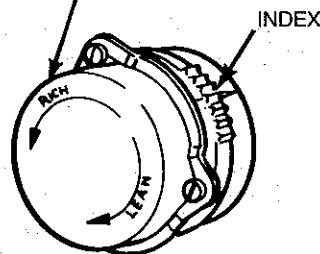

FIG. 9 - CHOKE ADJUSTMENT

1 Turn engine off

2 Close choke

3 Adjust fast idle screw

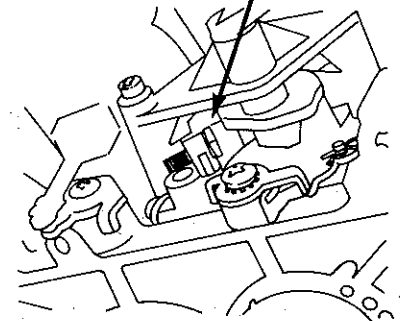

FIG. 10 - FAST IDLE ADJUSTMENT (NON-MARINE ONLY)

# NOMENCLATURE

| REF. NO.  | REF. NO.  | REF. NO.                           |
|---|---|------------------------------------|
| 1. Fast Idle Cam Plate Screw                                | 35. Secondary Diaphragm Spring                                    | 66. Acc. Pump Diaphragm Assy.      |
| 2. Choke Lever and Swivel Assy.                             | 36. Secondary Diaphragm & Link Assy.                              | 67. Pump Diaphragm Return Spring   |
| 3. Fast Idle Cam Plate                                      | 37. Check Ball  | 68. Pump Check Valve               |
| 4. Fast Idle Cam Spring                                     | 38. Secondary Diaphragm Housing                                   | 69. Power Valve Cover Screw        |
| 5. Fast Idle Cam  | 39. Secondary Diaphragm Housing Gasket                            | 70. Power Valve Cover              |
| 6. Retainer-Choke Rod                                       | 40. Secondary Diaphragm Lever Assy.                               | 71. Power Valve Cover Gasket       |
| 7. Choke Lever Back-up Plate                                | 41. Cotter Pin-Throttle Connecting Rod                            | 72. Power Valve-Primary            |
| 8. Choke Rod Lever Molded                                   | 42. Secondary Connecting Rod                                      | 73. Power Valve-Secondary          |
| 9. Choke Lever Spring                                       | 43. Secondary Operating Link                                      | 74. Power Valve Gasket             |
| 10. Choke Spring Ret. Washer                                | 44. Throttle Stop Screw   | 75. Choke Shaft and Lever Assy.    |
| 11. Push Nut Fastener                                       | 45. Throttle Stop Adj. Screw Spring                               | 76. Choke Rod                      |
| 12. Fast Idle Cam Lever & Sec. Diaphragm Lever Screw & L.W. | 46. E-Ring Retainer   | 77. Choke Rod Seal                 |
| 13. Cam Pick-up Lever                                       | 47. Pump Operating Lever Assy.                                    | 78. Choke Plate                    |
| 14. Fast Idle Adj. Screw                                    | 48. Fibre Locking Nut   | 79. Air Cleaner Stud               |
| 15. Fast Idle Cam Lever                                     | 49. Pump Lever Adj. Screw Spring                                  | 80. Fuel Inlet Fitting             |
| 16. Thermostat Cap Clamp Screw                              | 50. Pump Lever Stud   | 81. Fuel Inlet Fitting Gasket      |
| 17. Thermostat Cap Clamp                                    | 51. Pump Cam Screw  | 82. Fuel Valve Seat Screw          |
| 18. Thermostat & Cap Assy. Indexed                          | 52. Pump Cam  | 83. Seat Lock Screw Gasket         |
| 19. Thermostat Cap Gasket                                   | 53. Throttle Plate Screw  | 84. Fuel Valve Seat Lock Nut       |
| 20. Compression Nut   | 54. Primary Throttle Plate  | 85. Needle & Seat Adj. Nut Gasket  |
| 21. Choke Housing Screw                                     | 55. Secondary Throttle Plate                                      | 86. Fuel Inlet Needle & Seat Assy. |
| 22. Hex Nut   | 56. Primary Throttle Lever  | 87. O-Ring Seal                    |
| 23. Lockwasher  | 57. Primary Throttle Return Spring                                | 88. Airhorn Screw                  |
| 24. Choke Thermostat Lever Spacer                           | 58. Throttle Lever Bushing  | 89. Airhorn Gasket                 |
| 25. Choke Thermostat Lever & Piston Assy.                   | 59. Throttle Shaft and Stop Lever Assy.                           | 90. Float and Tab Assy.            |
| 27. Choke Housing & Plugs Assy.                             | 60. Secondary Throttle Shaft & Lever Assy. (Vacuum Secondary)     | 91. Float Shaft                    |
| 28. Choke Housing Shaft & Lever Assy.                       | 61. Secondary Throttle Shaft & Lever Assy. (Mechanical Secondary) | 92. Nozzle Bar Screw-Primary       |
| 29. Fast Idle Cam Assy.                                     | 62. Throttle Return Spring Pin                                    | 93. Nozzle Bar Screw-Secondary     |
| 30. Choke Housing Gasket                                    | 63. Pump Diaphragm Cover Screw                                    | 94. Nozzle Bar Screw Gasket        |
| 31. E-Ring Retainer   | 64. Acc. Pump Diaphragm Cover Assy.                               | 95. Primary Nozzle Bar Assy.       |
| 32. Secondary Diaphragm Housing Screw                       |   | 96. Secondary Nozzle Bar Assy.     |
| 33. Secondary Diaphragm Cover Screw                         |   | 97. Nozzle Bar Gasket              |
| 34. Secondary Diaphragm Cover                               |   | 98. Primary Main Jet               |
|   |   | 99. Secondary Main Jet             |
|   |   | 100. Fuel Level Check Plug         |
|   |   | 101. Fuel Level Plug Gasket        |
|   |   | 102. Idle Adj. Needle              |
|   |   | 103. Idle Adj. Needle Spring       |
|   |   | 104. Flange Gasket                 |

## ADJUSTMENT SPECIFICATIONS

| Carburetor Number                  | Choke Cap Setting | Pump Cam Position | Choke Unloader | Choke Quality |
|------------------------------------|-------------------|-------------------|----------------|---------------|
| R-84014, R-84015, R-84016, R-84017 |                   | No.2              |                |               |
| R-84021                            |                   | No. 2             | .185"          | .328"         |
| R-84024, R-84026                   | INDEX             | No. 2             | .185"          | .328"         |