

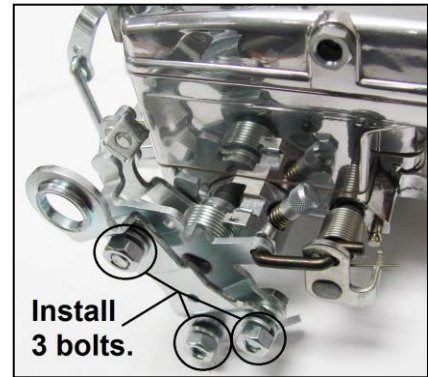

GM Throttle Extension Lever P/N 1952

1. Bolt the lever in position shown using the 3 sets of fasteners.
2. Please check for full throttle lever travel without binding or interference. An air cleaner spacer may be needed depending on which air cleaner assembly that you use.



Printed in U.S.A.

www.demoncarbs.com

Tech Service: 1-270-901-3346

Copyright © 2012

LIT711

Revision Date: 2-2-16



GM Throttle Extension Lever P/N 1952

1. Bolt the lever in position shown using the 3 sets of fasteners.
2. Please check for full throttle lever travel without binding or interference. An air cleaner spacer may be needed depending on which air cleaner assembly that you use.

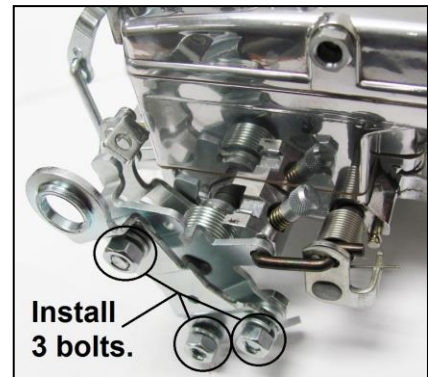

Printed in U.S.A.

www.demoncarbs.com

Tech Service: 1-270-901-3346

Copyright © 2012

LIT711

Revision Date: 2-2-16



GM Throttle Extension Lever P/N 1952

1. Bolt the lever in position shown using the 3 sets of fasteners.
2. Please check for full throttle lever travel without binding or interference. An air cleaner spacer may be needed depending on which air cleaner assembly that you use.

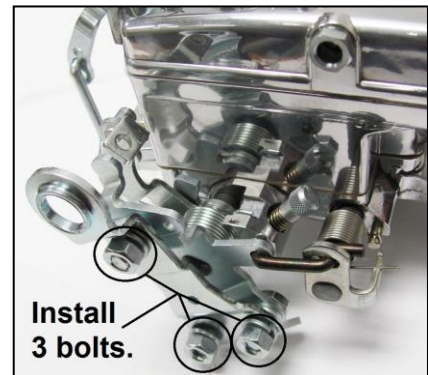

Printed in U.S.A.

www.demoncarbs.com

Tech Service: 1-270-901-3346

Copyright © 2012

LIT711

Revision Date: 2-2-16