

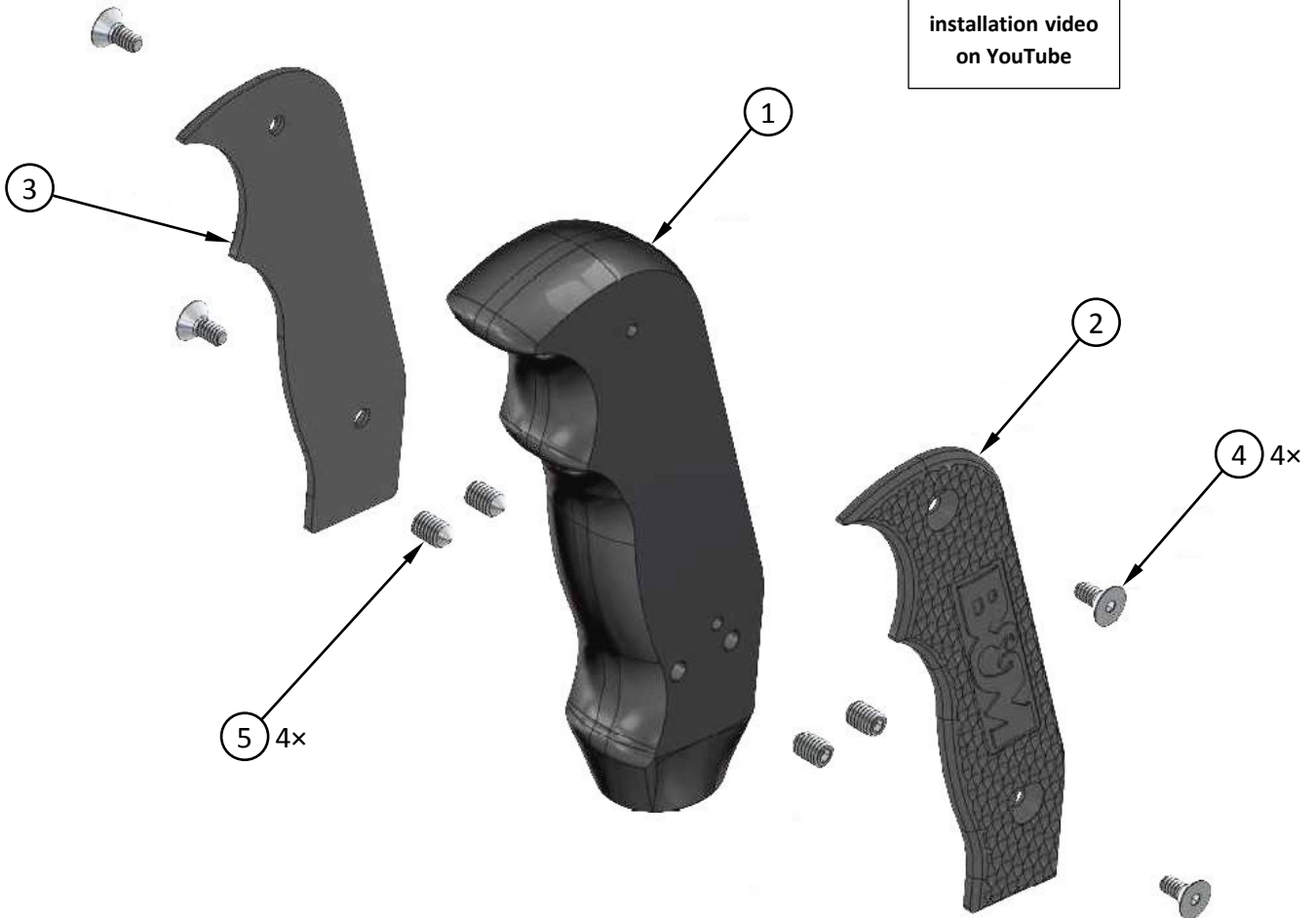

Installation Instructions for
MAGNUM GRIP SHIFTER HANDLE
for 2008-2017 POLARIS RZR
Catalog No. (Grip Color): 81089 (Black);
81140 (Blue); 81141 (Green); 81142 (Orange);
81143 (Red); 81144 (White); 81145 (Yellow)



Watch our
installation video
on YouTube



REFER TO PARTS LIST ON NEXT PAGE



Installation Instructions for
MAGNUM GRIP SHIFTER HANDLE
 for 2008-2017 POLARIS RZR
 Catalog No. (Grip Color): 81089 (Black);
 81140 (Blue); 81141 (Green); 81142 (Orange);
 81143 (Red); 81144 (White); 81145 (Yellow)

PARTS LIST

ITEM NO.	PART NO.	DESCRIPTION	QTY.
1	4001717-88	MAGNUM GRIP SHIFTER HANDLE BODY, POLARIS RZR	1
2	4001492-88	MAGNUM GRIP SHIFTER PLATE, LEFT, DIAMOND KNURL – BLACK	1
	4001724-88	" " " " " " " " – BLUE	
	4001732-88	" " " " " " " " – GREEN	
	4001730-88	" " " " " " " " – ORANGE	
	4001726-88	" " " " " " " " – RED	
	4001734-88	" " " " " " " " – WHITE	
	4001728-88	" " " " " " " " – YELLOW	
3	4001495-88	MAGNUM GRIP SHIFTER PLATE, RIGHT, DIAMOND KNURL – BLACK	1
	4001725-88	" " " " " " " " – BLUE	
	4001733-88	" " " " " " " " – GREEN	
	4001731-88	" " " " " " " " – ORANGE	
	4001727-88	" " " " " " " " – RED	
	4001735-88	" " " " " " " " – WHITE	
	4001729-88	" " " " " " " " – YELLOW	
4	3401537-00	SCREW, SOCKET, FLAT HEAD, 6-32 × 5/16", STAINLESS	4
5	3401538-00	SET SCREW, CONE POINT, 10-32 × 5/16", 18-8 SS	4

Before starting, take a moment to read and understand these instructions for your B&M Magnum Grip Shifter Handle. Use the parts drawing and list to verify your kit's contents. In the unlikely event of missing parts, please contact B&M Technical Support for replacements.

We highly recommend that you retain all factory parts.



1. **Turn off your vehicle's ignition and set the parking brake.** Carefully remove the stock shifter handle cap with a flat tip screwdriver or plastic trim tool.



4. Slide the shifter handle body all the way onto the shifter lever.



2. Remove the shifter handle screw, then pull the handle off the shifter lever.



5. Tighten all 4 set screws to secure the shifter handle to the shifter lever.



3. Thread the 4 set screws (Item 5) about 2-3 turns into the shifter handle body (1). (Two screws each side.)



6. Install the left and right side plates (2) and (3) with the 4 flathead screws (4). (Two screws each side.)

Congratulations, the installation of your B&M Magnum Grip Shifter Handle is now complete!