

Installation Instructions for
81231
SHIFTER HANDLE - GREEN
FOR 2018-2019 TEXTRON WILDCAT

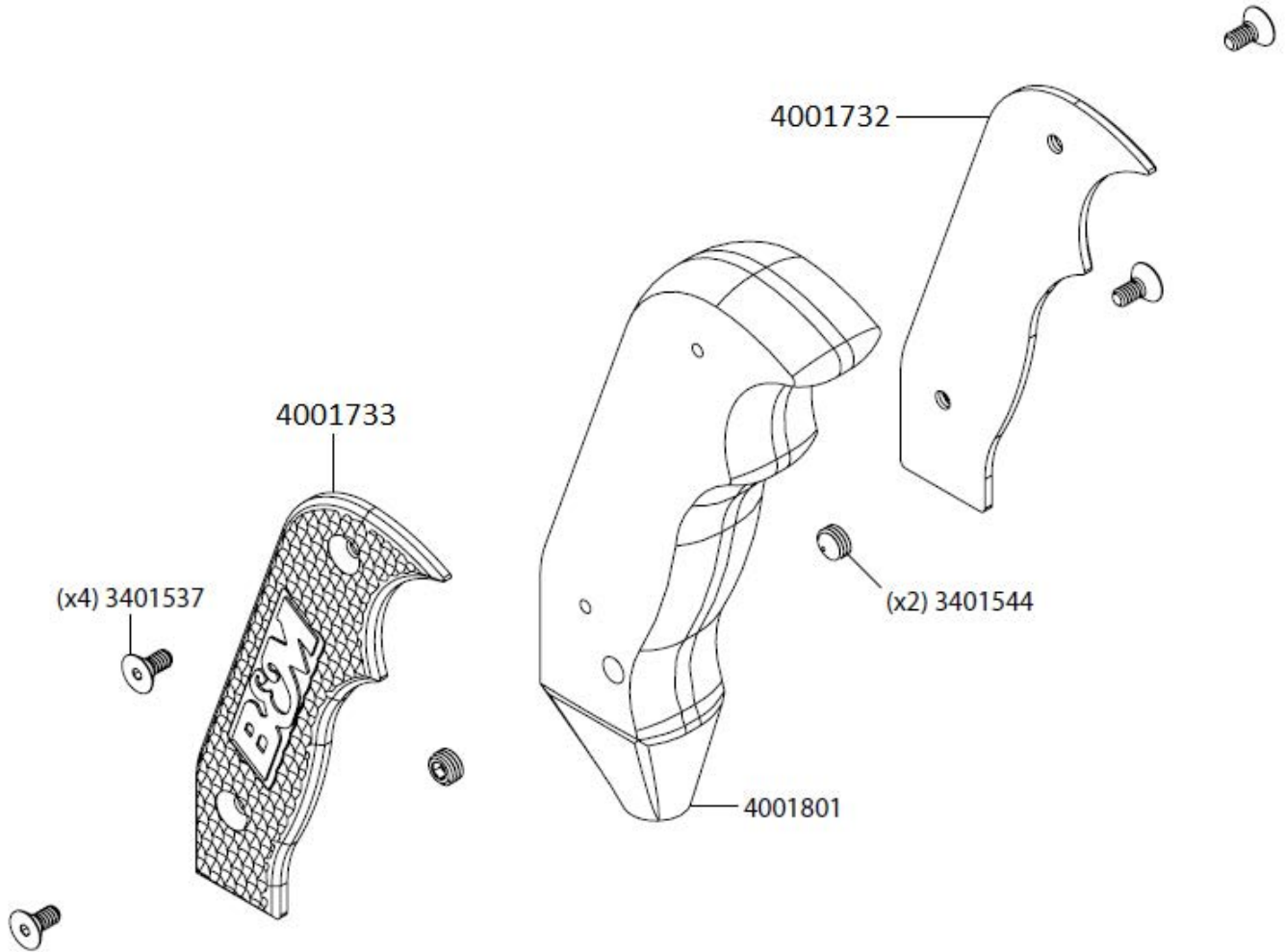

PART NO.	DESCRIPTION	QTY.
4001801	Handle Body	1
4001732	Left Shifter Plate	1
4001733	Right Shifter Plate	1

PART NO.	DESCRIPTION	QTY.
81230BA	Hardware Pack includes:	1
3401544	¼ - 28 x ¾" Set Screw	2
3401537	6 - 32 x ¾" Screw	4

OVERVIEW:

Thank you for purchasing **XDR Shifter Handle**. This kit comes in four different color schemes, each one given a unique part number: Black (**81230**), Green (**81231**), Orange (**81232**) and Blue (**81233**). The following assembly instructions apply to all color variations of this product.



1. Please take a moment to read and understand these instructions before installing your purchased performance kit. Use parts drawing and list to verify kit contents.

REMOVE STOCK SHIFTER COMPONENTS:



2. Turn off vehicle and chock tires, then carefully remove stock shifter handle.



3. Remove stock nut from shifter stem.

INSTALL YOUR XDR SHIFTER HANDLE:



4. Thread **handle body (4001801)** onto shifter stem. Tighten it fully until it faces dashboard.

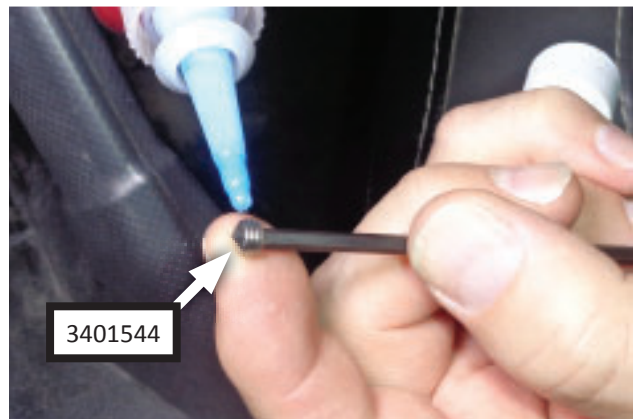

5. Apply loktite to $\frac{1}{4}$ - 28 x $\frac{3}{16}$ " set screws (x2) (**3401544**).

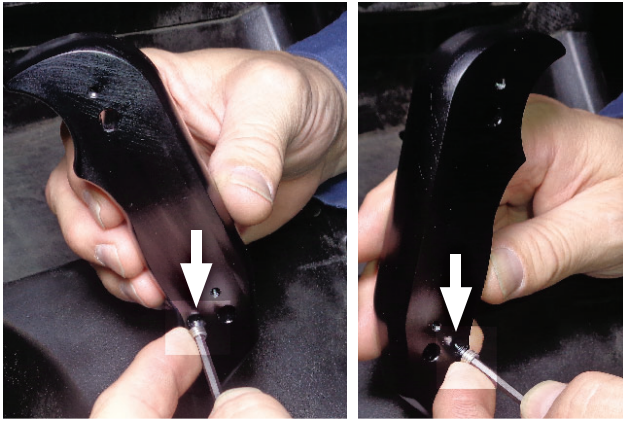

6. Install set screws onto handle body as shown.

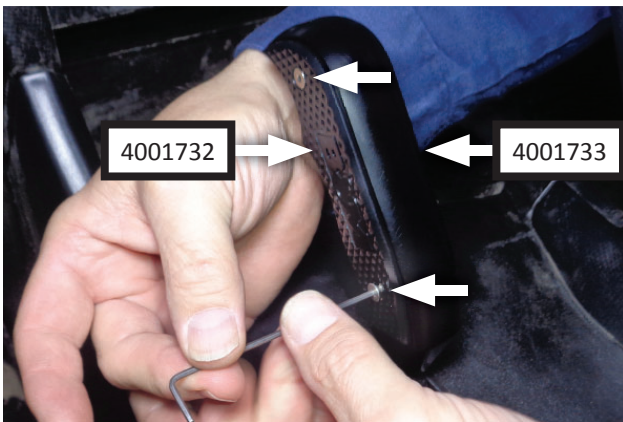

7. Install left and right shifter plates (4001732, 4001733) onto handle body using 6-32 x 5/16" screws (x4) (3401537).



Congratulations, the installation of your XDR Textron Wildcat Shift Handle is now complete!

SHOP MORE XDR PRODUCTS:

XDR is a Powersports division resulting from a joint effort by B&M Racing and Flowmaster to provide customers with the ultimate in off-road performance. To access a full range of XDR SXS/UTV products (like those pictured below) visit the website listed at the bottom of the page.



NOTE: We maintain a highly trained technical service department to answer your technical questions, provide additional product information and offer various recommendations.

XDR[™]
B&M / FLOWMASTER OFF-ROAD GROUP