

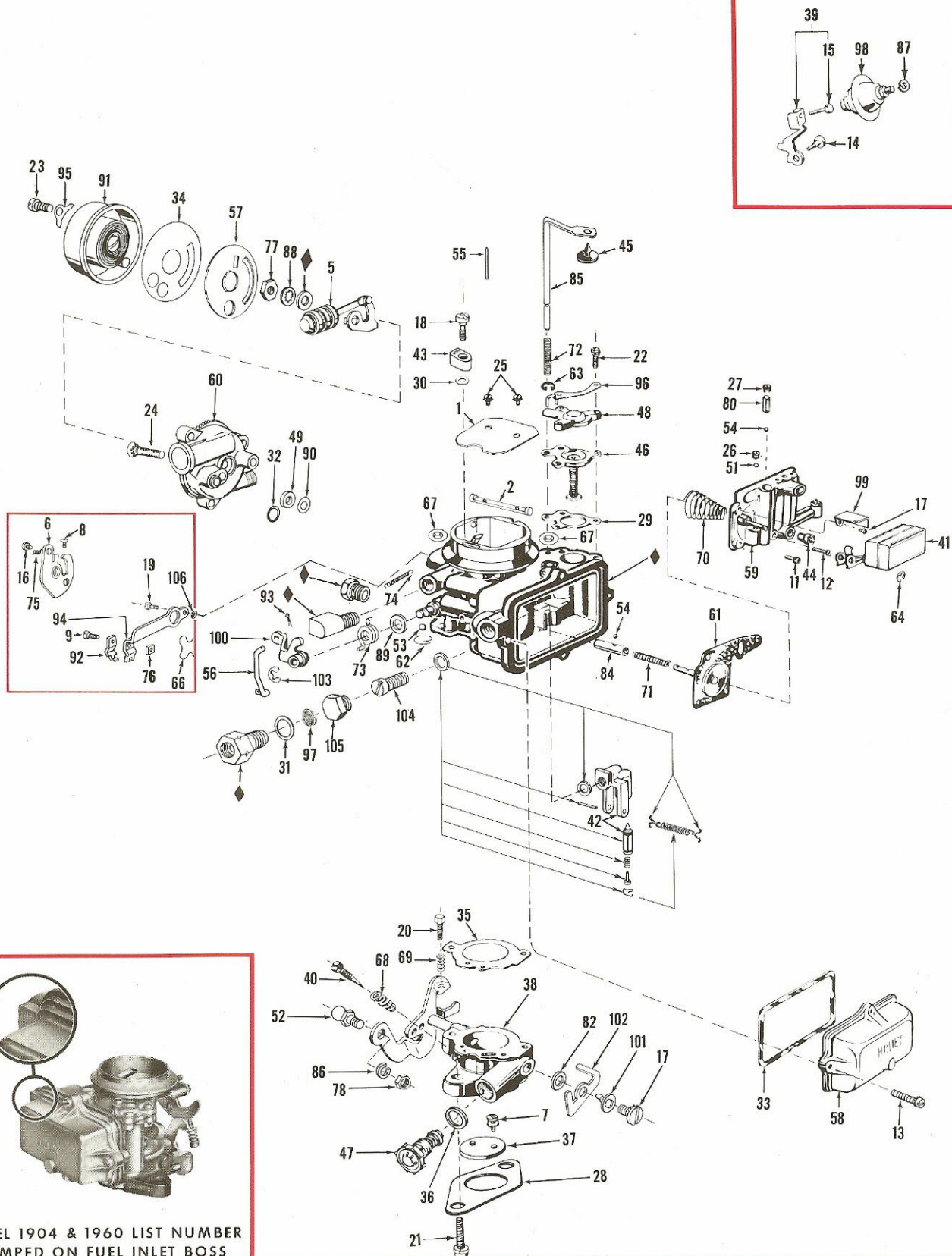

CARBURETION

# TYPICAL VIEW ILLUSTRATION NO. 2-2

MODEL 1904, 1960



MODEL 1904 & 1960 LIST NUMBER  
STAMPED ON FUEL INLET BOSS

See Service Parts List for items not illustrated here.

Parts having ♦ designation are not available for service.



Refer to Numerical Listing Section for Variable Parts

Index Number	Letter	Part Name	Part Number or Reference Section	Index Number	Letter	Part Name	Part Number or Reference Section
1	L	Choke Plate Assy.	X	57	L	Choke Hsg. Plate	34R-2757
2	L	Choke Shaft or Shaft & Lever Assy.	X	58	L	Float Bowl	34R-3382
5	L	Choke Therm. Lev. Link & Piston Assy.	X	59	L	Main Well & Econ. Body & Plugs Assy.	X
6	L	Choke Lev. Assy.	X	60	L	Choke Hsg. & Plugs Assy.	X
7	L-M	Throt. Plate Scr. & L. W.	X	61	L-M-P	Pump Diaph. & Rod Assy.	X
8	L	Choke Lev. Swivel Scr.	5R-167	62	L-M	Spark Check Ball Ret.	36R-162
9	L	Choke Brkt. Clamp Scr.	5R-641	63	L-M	Vent Rod Sprg. Ret.	36R-169
11	L	Main Well & Econ. Body Scr. & L. W. (Short)	† 5R-420	64	L	Float Ret.	36R-169
12	L	Main Well & Econ. Body Scr. & L. W. (Long)	5R-421	66	L	Choke Shaft Ret.	36R-276
13	L	Float Bowl Clamp Scr. & L. W.	5R-425	67	L	Air Cleaner Bail Ret.	36R-323
14	L	Dashpot Lev. Scr.	X	68	L	Idle Adj. Needle Sprg.	38R-108
15	L	Dashpot Lev. Adj. Scr.	5R-447	69	L	Throt. Stop Scr. Sprg.	38R-110
17	L	Baffle & Vent Scr. & L. W.	5R-476	70	L	Pump Return Sprg.	† 38R-395
18	L	Pump Discharge Nozzle Scr.	X	71	L	Pump Oper. Sprg.	38R-452
19	L	Choke Brkt. Scr. & L. W.	X	72	L	Vent Rod Sprg.	38R-615
20	L	Throt. Stop Scr.	X	73	L	Pump Oper. Lev. Sprg.	38R-638
21	L	Throt. Body Scr. & L. W.	5R-571	74	L	Choke Lev. Sprg.	38R-759
22	L	Econ. Body Scr. & L. W.	5R-641	76	L	Choke Brkt. Clamp Nut	39R-1
23	L	Therm Hsg. Scr.	5R-641	77	L	Choke Shaft Nut	X
24	L	Choke Hsg. Scr. & L. W.	5R-806	78	L	Throt. Lev. Ball Nut	39R-11
25	L-M	Choke Plate Scr. & L. W.	X	80	L	Pump Discharge Valve Weight	X
26	L	Pump Inlet Ball Ret.	X	82	L	Vent. Oper. Lev. Spacer	40R-390
27	L	Pump Discharge Ball Ret.	7R-48-3	84	L	Pump Push Rod Sleeve	X
28	G-M-P	Flange Gskt.	X	85	L	Vent Rod	43R-305
29	G-M-P	Econ. Body Gskt.	X	86	L	Throt. Lev. Ball L. W.	46R-2
30	G-M-P	Pump Discharge Nozzle Gskt.	X	87	L	Dashpot L. W.	46R-10
31	G-M-P	Fuel Inlet Fitting Gskt.	X	88	L	Choke Shaft Nut L. W.	46R-252
32	G-M-P	Choke Hsg. Gskt.	X	89	L	Pump Oper. Lev. Sprg. Washer	46R-474
33	G-M-P	Float Bowl Gskt.	X	90	L	Choke Shaft Seal Washer	X
34	G-M-P	Choke Therm. Hsg. Gskt.	X	91	L	Choke Therm. Hsg. Assy.	X
35	G-M-P	Throt. Body Gskt.	X	92	L	Choke Brkt. Clamp	49R-149
36	G-M-P	Spark Valve Gskt.	X	93	L-M	Pump Oper. Link Cotter Pin	48R-183
37	L	Throt. Plate	X	94	L	Choke Brkt.	X
38	L	Throt. Body, Shaft & Lev. Assy.	X	95	L	Choke Therm. Hsg. Clamp	49R-128
39	L	Dashpot Lev. Assy.	X	96	L	Vent Rod Guide	49R-538
40	L-M	Idle Adj. Needle	X	97	L	Filter Screen	57R-27
41	L	Float & Lev. Assy.	X	98	L	Dashpot Assy.	11-3
42	L-M-P	Fuel Inlet Valve & Seat Assy.	X	99	L	Fuel Inlet Baffle	59R-50
43	L	Pump Discharge Nozzle	X	100	L	Pump Oper Lev.	X
44	L	M.M.J. - 22R-40-(Size)	X	101	L	Vent Control Lev.	63R-518
45	L	Vent Rod Valve	23R-453	102	L	Vent Oper. Lev.	63R-559
46	L-M-P	Econ. Stem Assy.	X	103	L	Pump Oper. Lev. Ret.	75R-37
47	L-M	Spark Valve Assy.	X	104	L	Fuel Inlet Seat Screw	5R-423
48	L	Econ. Body Cover Assy.	25R-167	105	L	Fuel Inlet Plug	7R-255
49	L-G-M-P	Choke Shaft Seal	27R-204	106	L	Choke Brkt. Scr. L. W.	46R-2
51	L-M	Pump Inlet Ball	28R-6	**	L	Fast Idle Adj. Scr.	5R-763
52	L	Throt. Lev. Ball	X	**	L	Fast Idle Adj. Scr. Nut	39R-39
53	L-M	Spark Check Ball	28R-31	**	L	Fuel Bowl Vent Lev. Sprg.	38R-811
54	L-M	Pump Discharge & Push Rod Sleeve Ball	28R-94	**	L	Fuel Bowl Vent. Lev.	65R-24
55	L	Distribution Pin	X	*	L	Fuel Bowl Vent Valve	65R-27
56	L-M	Pump Oper. Link	X	*	L	Fuel Bowl Vent. Lev. Ret.	75R-37
				*	L	Air Horn Adapter Gskt.	8R-1090
				*	L	Fuel Line Fitting Elbow	19R-299
				*	L	Fuel Line Adapter Assy.	52R-90A
				*	L	Air Horn Adapter	61R-297A
				*	L	Gulp Valve Connector	19R-374

NOTE: "X" Symbol Indicates "Refer to Numerical Listing Section for Specific Part Required" G = Gasket Kit; L = Loose Parts; M = Master Kit; P = Pep Kit

\*Not shown on typical view. These are packaged with some service units to provide a more universal coverage.

\*\*Not shown on typical view. These are used only on carburetor numbers R-1915A, R-1915-1A and R-1915-1AS.

† Use (2) 5R-1089 Screw and 38R-1194 Spring on R-3117A & 1A only.