

**TYPICAL VIEW
ILLUSTRATION NO. 17-2**

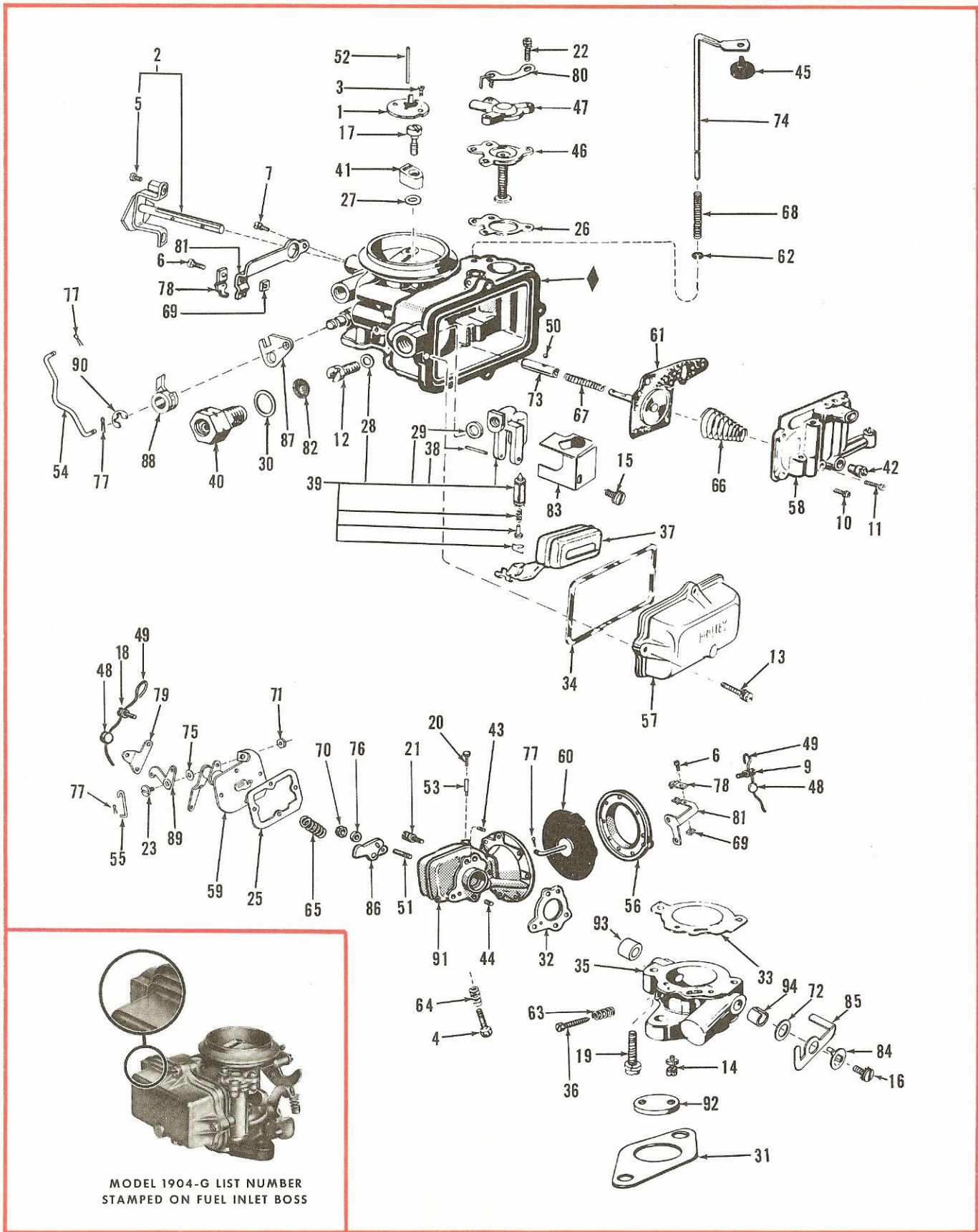

MODEL 1904-G LIST NUMBER
STAMPED ON FUEL INLET BOSS

See Service Parts List for items not illustrated here.

Parts having ♦ designation are not available for service.



Refer to Numerical Listing Section for Variable Parts

Index Number	Letter	Part Name	Part Number or Reference Section	Index Number	Letter	Part Name	Part Number or Reference Section
1	L	Choke Plate Assy.	X	49	G-L-M	Gov. Cover Seal Wire	27R-52
2	L	Choke Shaft & Lev. Assy.	X	50	L-M	Pump Push Rod Sleeve Ball	28R-94
3	L-M	Choke Plate Scr.	X	51	L	Gov. Spring Pin (Long)	29R-96
4	L	Idle Adj. Scr.	X	52	L	Distribution Pin	29R-339
5	L	Choke Lev. Swivel Scr.	5R-167	53	L	Fast Idle Pin	29R-763
6	L	Choke Brkt. Clamp Scr.	5R-641	54	L	Pump Connecting Link	X
7	L	Choke Brkt. Scr. & L. W.	5R-369	55	L-M	Pump Oper. Link	33R-434
9	L	Gov. Diaph. Cover Scr. & L. W. (Drilled)	5R-371	56	L	Gov. Diaph. Cover Assy.	34R-422A
10	L	Main Well & Econ. Body Scr. & L. W. (Short)	5R-420	57	L	Float Bowl	34R-3382
11	L	Main Well & Econ. Body Scr. & L. W. (Short)	5R-421	58	L	Main Well & Econ. Body & Plugs Assy.	X
12	L	Fuel Inlet Seat Scr.	X	59	L	Gov. Hsg. Cover & Lever Assy.	X
13	L	Fuel Bowl Scr. & L. W.	5R-425	60	L-M	Gov. Diaph. Assy.	35R-240A
14	L-M	Throt. Plate Scr. & L. W.	5R-476	61	L-M	Pump Diaph. & Rod Assy.	8-154
15	L	Baffle Scr. & L. W.	5R-476	62	L	Vent Rod Sprg. Ret.	36R-169
16	L	Vent Control Lev. Scr. & L. W.	5R-476	63	L	Idle Adj. Needle Sprg.	38R-108
17	L	Pump Disch. Nozzle Scr.	5R-492	64	L	Throt. Stop Scr. Sprg.	38R-110
18	L	Gov. Body Cover Scr. & L. W.	5R-367	65	L	Gov. Sprg.	X
19	L	Throt. Body Scr. & L. W.	5R-571	66	L	Pump Ret. Sprg.	38R-395
20	L	Fast Idle Pin Scr.	5R-624	67	L	Pump Oper. Sprg.	38R-452
21	L	Gov. Body Mounting Scr. & L. W.	5R-639	68	L	Vent Rod Sprg.	38R-615
22	L	Econ. Body Scr. & L. W.	5R-641	69	L	Choke Brkt. Clamp Nut	39R-1
23	L	Pump Connecting Lev. Scr.	5R-797	70	L	Gov. Lever Nut	39R-5
25	G-M	Gov. Hsg. Gskt.	X	71	L	Pump Connecting Lev. Scr. Lock Nut	39R-197
26	G-M	Econ. Body Gskt.	X	72	L	Vent. Oper. Lev. Spacer	40R-390
27	G-M	Pump Disch. Nozzle Gskt.	X	73	L	Pump Push Rod Sleeve	42R-200
28	G-M	Fuel Inlet Seat Scr. Gskt.	X	74	L	Vent Rod	43R-305
29	G-M	Fuel Inlet Seat Gasket	X	75	L	Pump Oper. Lev. Ret. Washer	46R-131
30	G-M	Fuel Inlet Fitting Gskt.	X	76	L	Gov. Lev. L. W.	46R-285
31	G-L-M	Flange Gskt.	8R-689	77	L-M	Pump Oper. Link Ret.	48R-183
32	G-M	Gov. Throt. Body Gskt.	X	78	L	Choke Brkt. Clamp	49R-149
33	G-M	Throt. Body Gskt.	X	79	L	Ret. Sprg. Brkt.	49R-371
34	G-M	Float Bowl Gskt.	X	80	L	Vent Rod Guide	49R-538
35	L	Throt. Body & Shaft Assy.	X	81	L	Choke Wire Brkt.	X
36	L-M	Idle Adj. Needle	15R-36	82	L	Filter Screen Cap	57R-27
37	L	Float & Lev. Assy.	X	83	L	Fuel Inlet Needle Seat Baffle	59R-50
38	L-M	Float Lev. Shaft	17R-31	84	L	Vent Control Lev.	63R-518
39	L-M	Fuel Inlet Valve & Seat Assy.	X	85	L	Vent Oper. Lev.	63R-559
40	L	Fuel Inlet Fitting	19R-146	86	L	Gov. Lev. Assy.	63R-604A
41	L	Pump Disch. Nozzle	X	87	L	Cam Holding Lev.	63R-616
42	L	Main Jet	X	88	L	Pump Oper. Lev.	63R-617
43	L	Gov. By-Pass Jet "B"	X	89	L	Pump Connecting Lev.	63R-636
44	L	Gov. By-Pass Jet "A"	X	90	L	Pump Oper. Lev. Ret.	75R-37
45	L	Vent Rod Valve	23R-453	91	L	Gov. Hsg. & Plugs Assy.	79R-693A
46	L-M	Econ. Diaph. & Stem Assy.	X	92	L	Throt. Plate	X
47	L	Econ. Body Cover Assy.	25R-167A	93	L	Throt. Shaft Bearing (Solid)	13R-616
48	G-L-M	Gov. Cover Seal	27R-51	94	L	Throt. Shaft Bearing (Ribbon)	13R-617

NOTE: "X" Symbol Indicates "Refer to Numerical Listing Section for Specific Part Required"

G = Gasket Kit; L = Loose Parts; M = Master Kit; P = Pep Kit