

# JAMMER

CAI

## INSTALL GUIDE

2014-2017 Silverado/Sierra 1500  
5.3L/6.2L

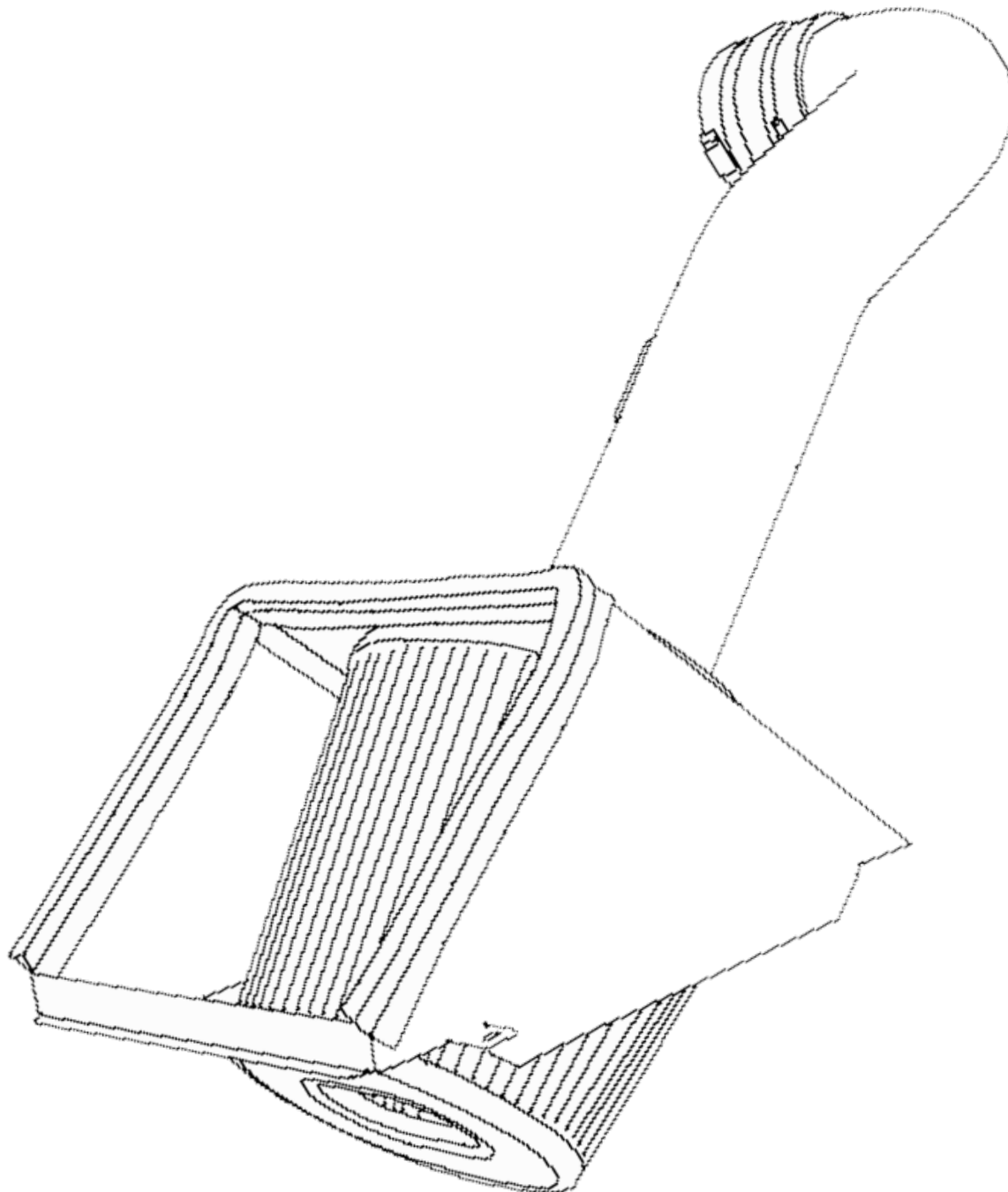

# TABLE OF CONTENTS

---

---

<b>3</b>	<b>GETTING STARTED</b>
3	PARTS LIST
<b>4</b>	<b>INSTALLATION INSTRUCTIONS</b>
4	REMOVING THE STOCK INTAKE ASSEMBLY
7	INSTALLING THE AIR FILTER
8	INSTALLING THE HOUSING
9	INSTALLING THE INTAKE TUBE
<b>10</b>	<b>WARRANTY</b>

# GETTING STARTED

## PARTS LIST

Item	Description	Qty
1	HOSE, 5/8" (15" in.).....	1
2	COUPLING, REDUCER.....	1
3	COUPLING, HUMP.....	1
4	CLAMP #060.....	2
5	CLAMP MINI.....	4
6	HOSE, 5/8" (12" in.).....	1
7	TRIM SEAL 7/16" (24" in.).....	1
8	AIR FILTER.....	1
9	NYLON SPACERS.....	3
10	HOUSING.....	1
11	INTAKE TUBE.....	1
12	SCREWS, M4 x .7 x 8mm.....	2

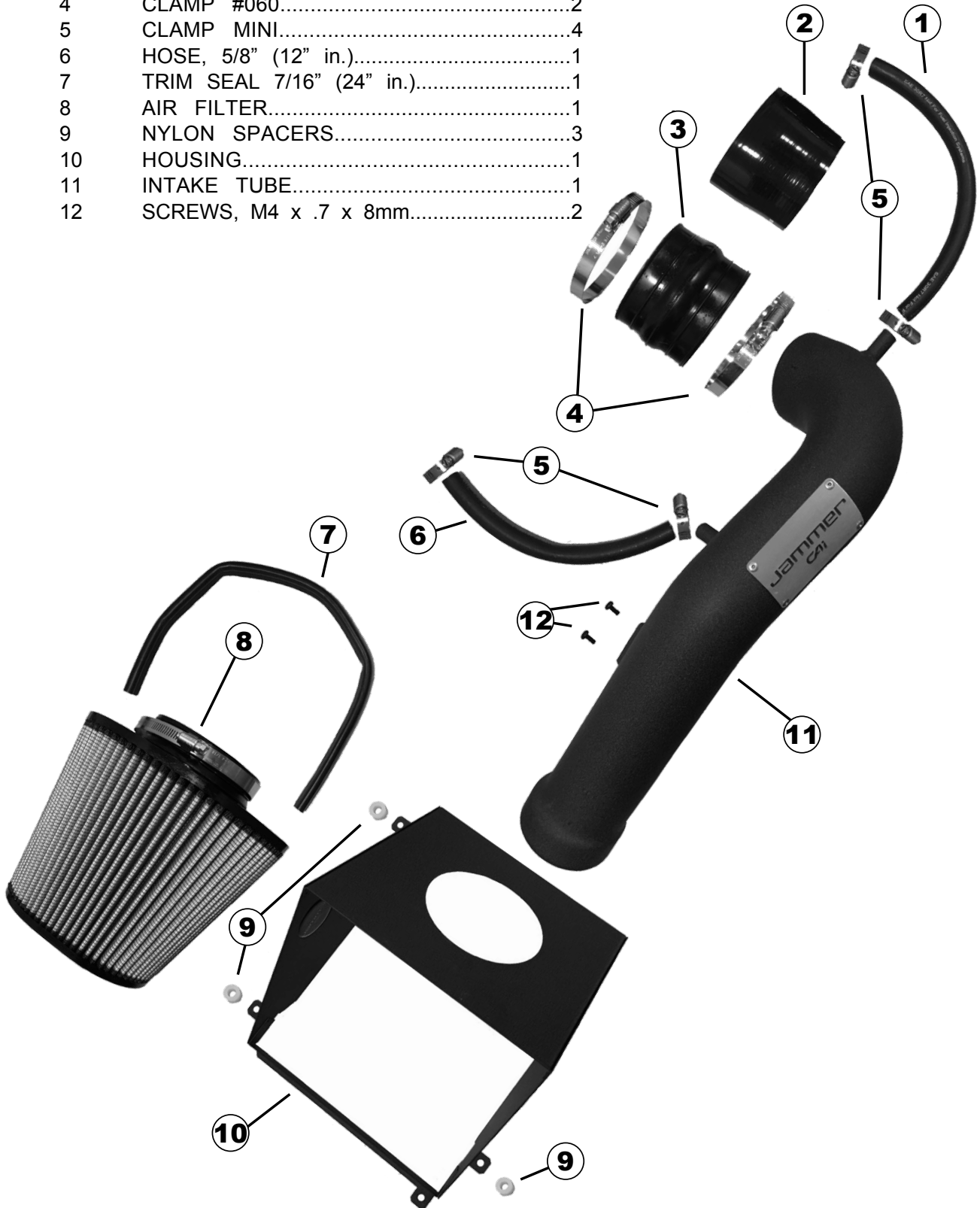

# INSTALLATION INSTRUCTIONS

## REMOVING THE STOCK INTAKE ASSEMBLY

*CAUTION: Disconnect the ground cable from the battery before installation.*

**STEP 1** - Disconnect the MAF sensor plug from stock intake tube.



**STEP 2** - Loosen clamp from factory air box housing and stock intake tube.

**STEP 3** - Loosen clamp from throttle body.

**STEP 4** - Disconnect the MAF sensor harness clip from the factory air box.

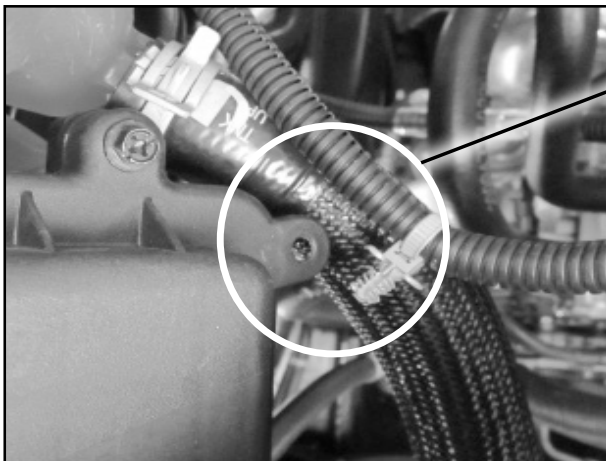

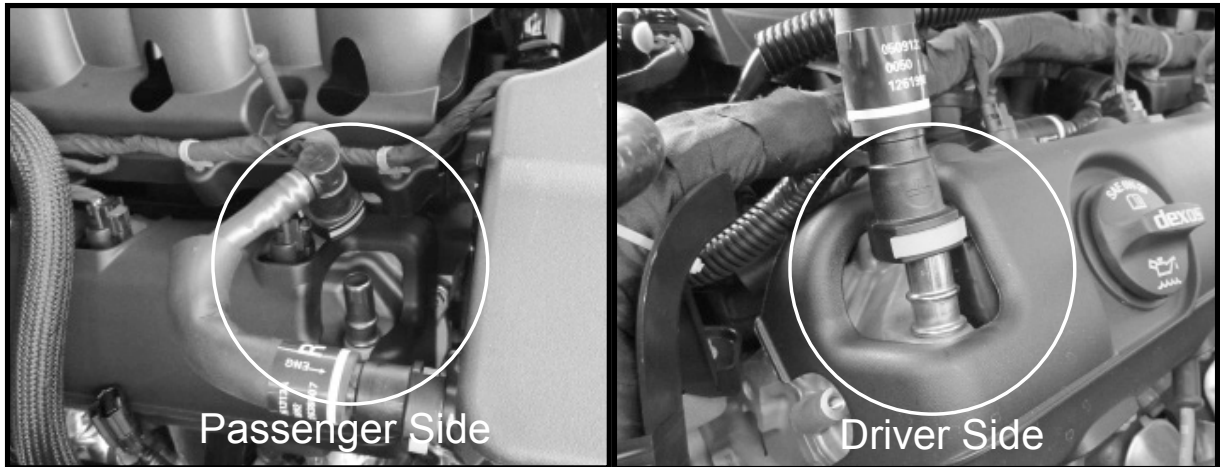

**STEP 5** - Disconnect the factory crank case breathers from the valve covers (as shown) on both sides of the engine.

**STEP 6** - Carefully remove the entire intake tube plenum with the crank case breather plugs attached.

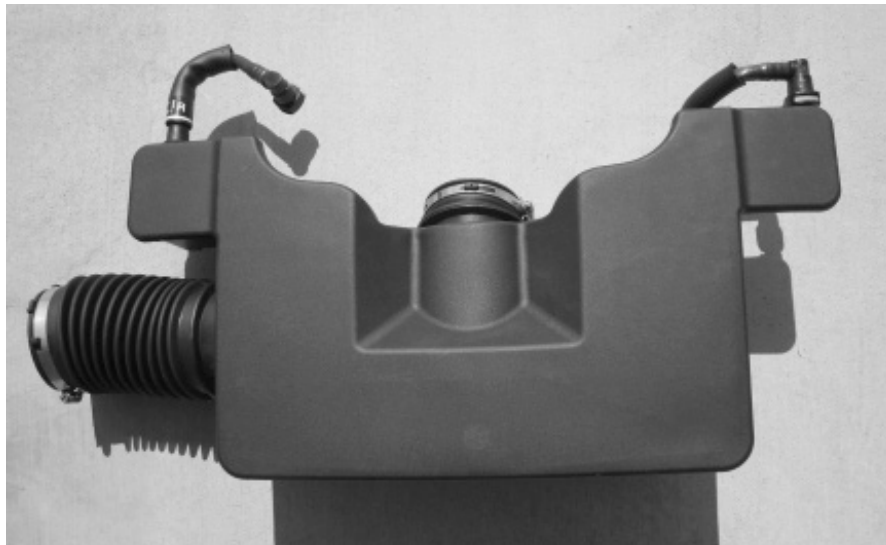

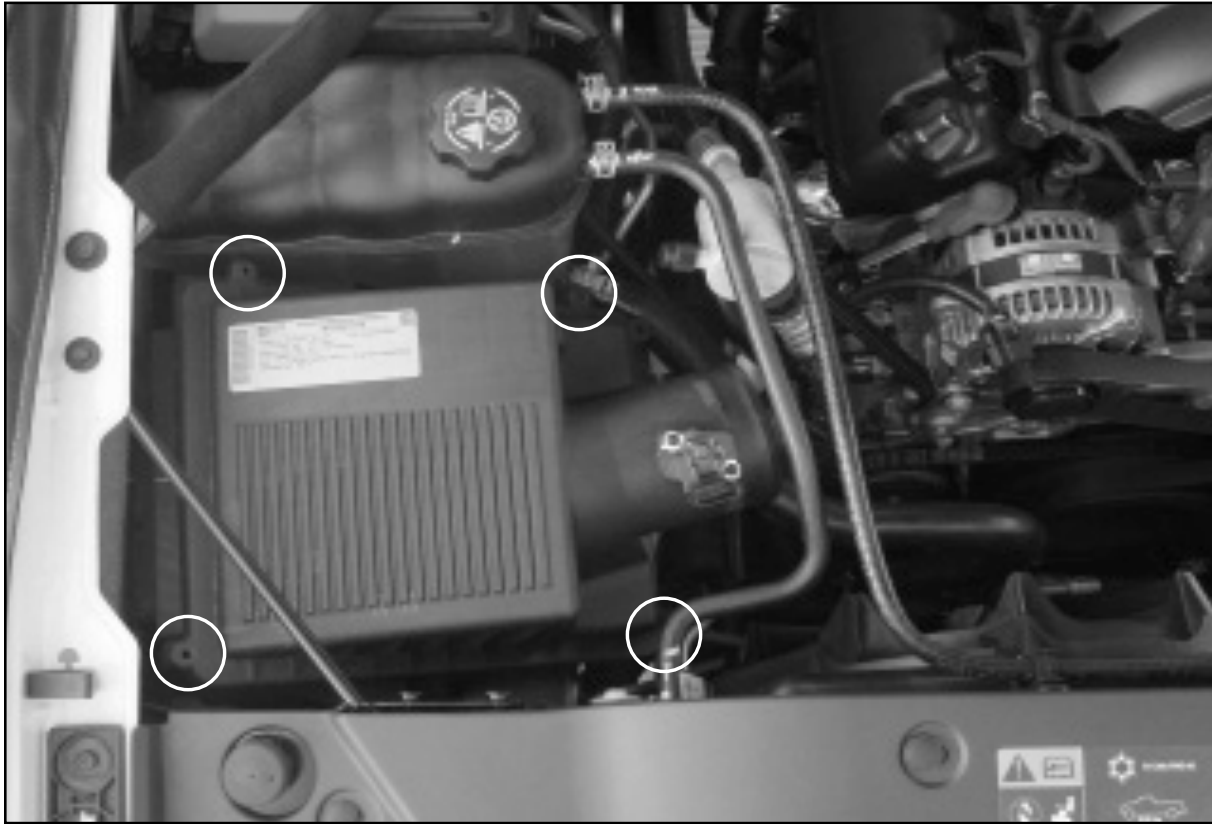

**STEP 7** - Remove the top portion of the stock intake housing by removing the 4 factory screws. Retain for later use.

**STEP 8** - Remove the stock filter from the intake housing.

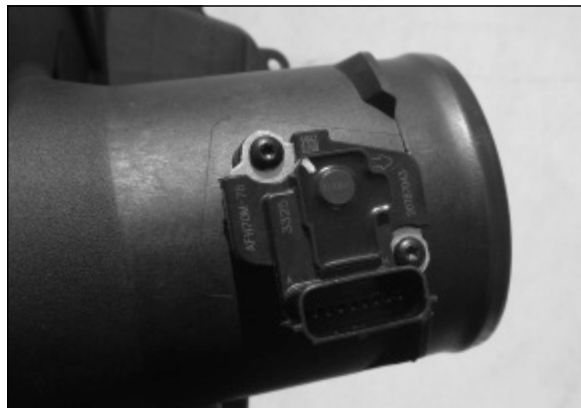

**STEP 9** - Remove the MAF sensor from the stock housing.

---

## INSTALLING THE AIR FILTER

---

**STEP 10** - Install MAF sensor from the stock housing into the Jammer intake tube using the provided screws.

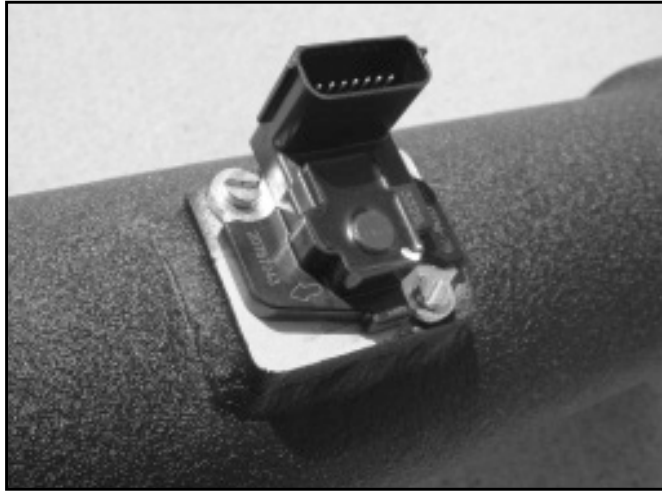

**STEP 11** - Install the trim seal on the edge of the top corners of the Jammer housing.



**STEP 12** - Install Jammer filter into housing along with clamp. Make sure it is secured in the filter retention groove that is molded into the filter neck.

---

## INSTALLING THE HOUSING

---

**STEP 13** - Install the Jammer housing using 3 factory screws removed earlier with the provided 3/8 nylon spacers.

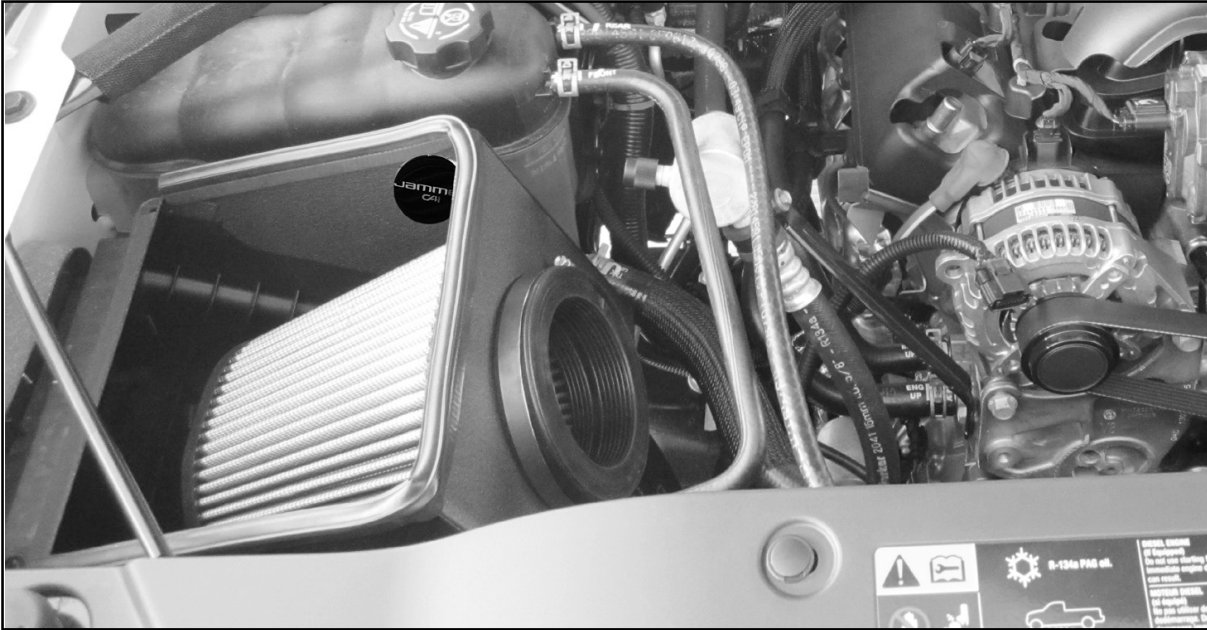

**STEP 14** - Install the coupler onto the throttle body with provided clamps. Use the hump coupling for 5.3L models or the reducer coupling for 6.2L models.

**STEP 15** - Install Jammer intake tube onto the filter, then onto the throttle body coupler.





---

## INSTALLING THE INTAKE TUBE

---



**STEP 16** - Install the crank case breathers onto both the passenger side and drivers side valve cover and attach it to the Jammer intake tube with the mini clamps and hose provided.

**STEP 17** - Reconnect MAF sensor harness coupler.

**STEP 18** - Make sure all clamps and connections are secure. Your installation is now complete.

***NOTE: Verify all connections are secure 100-200 miles after installation.***

# WARRANTY

---

Powerteq, LLC, (hereafter “SELLER”), subject to the conditions and limitations set forth herein, warrants to the original consumer purchaser only that each Jammer product sold by SELLER (the “Product”) through an authorized dealer will be free from defects in material and workmanship under normal operating conditions for one (1) year after the date of purchase. SELLER will repair or replace, at SELLER’s option, any Product that is found to be defective in material or workmanship under normal operating conditions during the one-year period after the date of purchase by the original consumer purchaser.

## **What Is Not Covered by This Warranty?**

This warranty does not apply to any of the following:

1. Loss, damage, repairs, or maintenance required as a result of accident, abuse, negligence, or misuse.
2. Loss, damage, repairs, or maintenance required as a result of any third-party tuning software.
3. Loss, damage, repairs, or maintenance required as a result of fire, water, hail, theft, earthquake, wind, ice, lightening, acts of god, accident, animals, corrosive atmosphere, or other external causes beyond the control of SELLER.
4. Any special, indirect, incidental, consequential, or punitive damages, including property damage, arising out of or related to the use or loss of use of the Product under this Limited Warranty.
5. Any Products purchased through auction websites.

## **Limitation of Liability**

The terms of this Limited Warranty constitute the entire agreement between the parties with respect to the Product. The original consumer purchaser’s exclusive remedy shall be limited to the repair or replacement of the defective product. EXCLUDING THE LIMITED WARRANTY PROVIDED ABOVE, SELLER, TO THE MAXIMUM EXTENT PERMITTED BY LAW, MAKES NO WARRANTIES, EXPRESSED OR IMPLIED, AND DISCLAIMS ALL WARRANTIES, DUEITES AND CONDITIONS, WHETHER EXPRESS, IMPLIED, OR STATUTORY, WITH RESPECT TO THE WORK, INCLUDING WITHOUT LIMITATION ANY IMPLIED WARRANTIES OF MERCHANTABILITY OR FITNESS FOR A PARTICULAR PURPOSE. ANY REMEDY IS LIMITED TO THE PURCHASE PRICE OF THE PRODUCT.

---

### **How to Make a Warranty Claim**

Contact Powerteq Customer Service. BUYER will be required to submit proof of purchase from an authorized dealer within 5 days of the warranty claim.

THE INSTALLATION OF THIS PRODUCT INDICATES THAT THE BUYER HAS READ AND UNDERSTANDS THIS AGREEMENT AND ACCEPTS ITS TERMS AND CONDITIONS. IN THE EVENT THAT THE BUYER DOES NOT AGREE WITH THIS AGREEMENT, THE BUYER MAY PROMPTLY RETURN THIS PRODUCT, IN A NEW AND UNUSED CONDITION, WITH A DATED PROOF OF PURCHASE, TO THE PLACE OF PURCHASE WITHIN THIRTY (30) DAYS FROM DATE OF PURCHASE FOR A FULL REFUND.

**COPYRIGHT© 2017 REV 00**

*For additional questions not found in the user guide call:*

**Powerteq Technical Support: (855) 292-2121 6:00 am - 5:00 pm MST**

**To expedite your support call, please have your Vehicle Information,  
Part Number, and Serial Number ready prior to calling Technical Support.**