

# JAMMER CAI

## INSTALL GUIDE

1997-2006  
Jeep Wrangler TJ  
4.0L L6



# TABLE OF CONTENTS

---

---

<b>3</b>	<b>GETTING STARTED</b>
3	PARTS LIST
<b>4</b>	<b>INSTALLATION INSTRUCTIONS</b>
4	REMOVING THE STOCK INTAKE ASSEMBLY
7	INSTALLING THE HOUSING
8	INSTALLING THE INTAKE TUBE
9	INSTALLING THE AIR FILTER
<b>10</b>	<b>WARRANTY</b>

# GETTING STARTED

## PARTS LIST

Item	Description	Qty
1	Air Filter.....	1
2	Housing.....	1
3	Intake Tube.....	1
4	Coupling, Hump.....	1
5	Coupling, Straight.....	1
6	Clamp Mini, #008.....	2
7	Clamp, #048.....	2
8	Clamp, #052.....	2
9	Grommet (Air Temp Sensor).....	1
10	Screw, Hex Hd: M6.....	2
11	Washer, Wavy: M6.....	2
12	Nut, Hex: M6.....	2
13	Washer, Fender: 1/4.....	4
14	Grommet, Rubber.....	1
15	Cap: 1/2.....	1
16	Hose, Fuel: 5/8 ID (12" inches).....	1

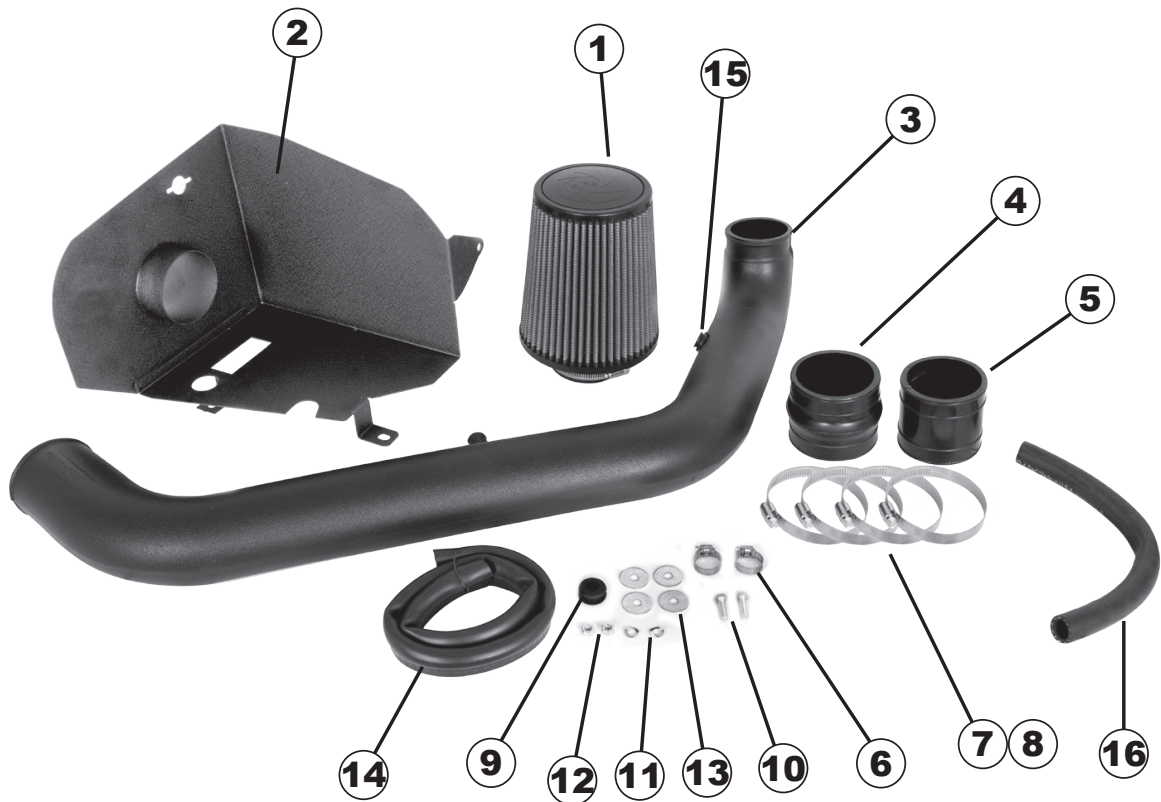

# INSTALLATION INSTRUCTIONS

## REMOVING THE STOCK INTAKE ASSEMBLY

*CAUTION: Disconnect the ground cable from the battery before installation.*

**STEP 1** - On vehicles equipped with a temp sensor, disconnect the harness to the sensor.

**STEP 2** - Using an 8mm nut driver, loosen the clamps at the airbox and the throttle body.

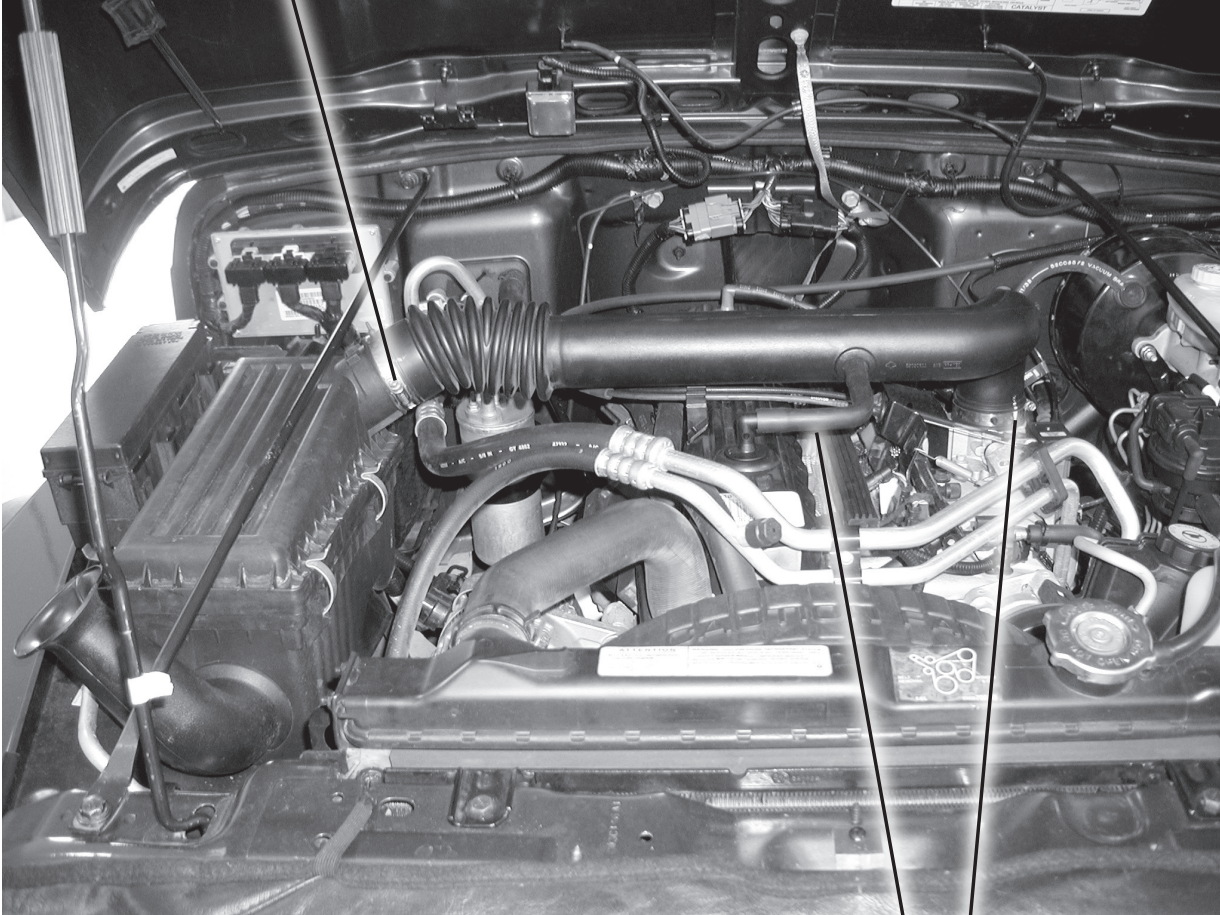

**STEP 3** - Disconnect the vent hose from the intake tube.

**STEP 4** - Remove the intake tube.

---

**STEP 5** - Unclip the five clamps holding down the airbox lid.

**STEP 6** - Remove the lid and the air filter.

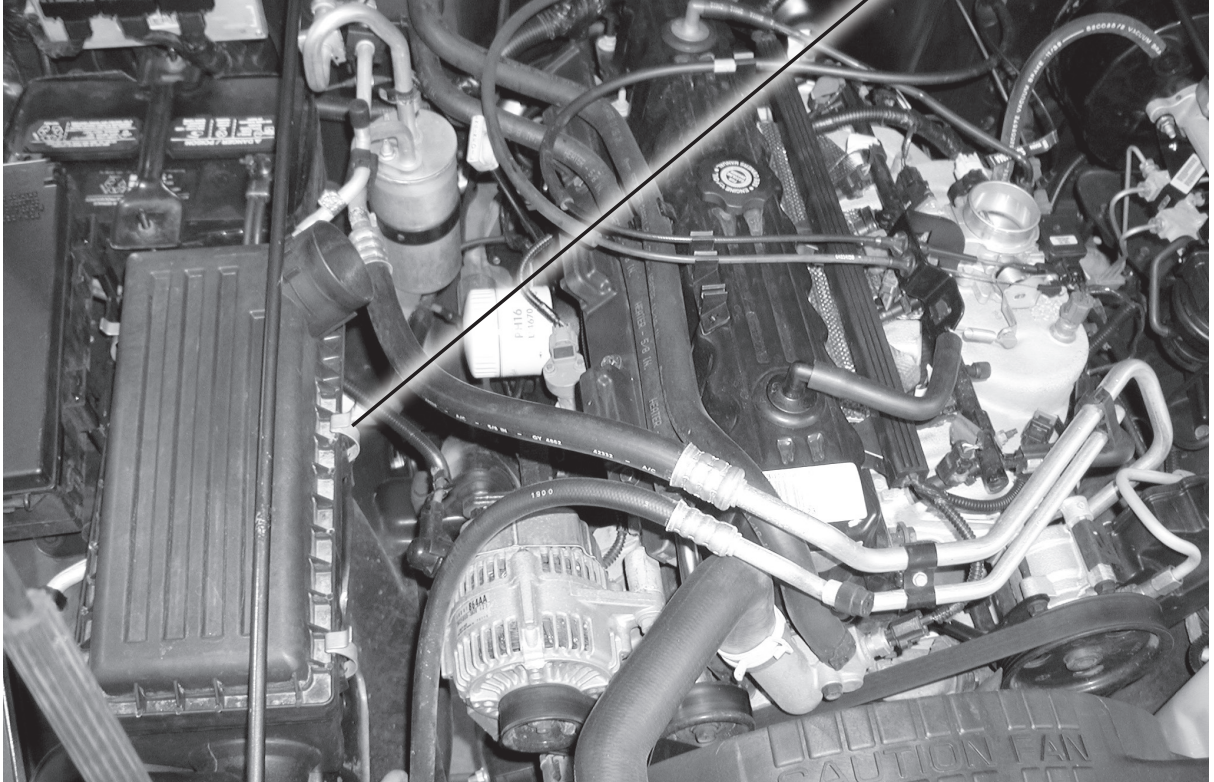

**STEP 7** - Remove the three screws holding the lower section of the airbox using a 10mm socket and ratchet. Remove the airbox.



---

**STEP 8** - Using a 13mm socket, remove the two screws holding the strut rod and remove the rod.

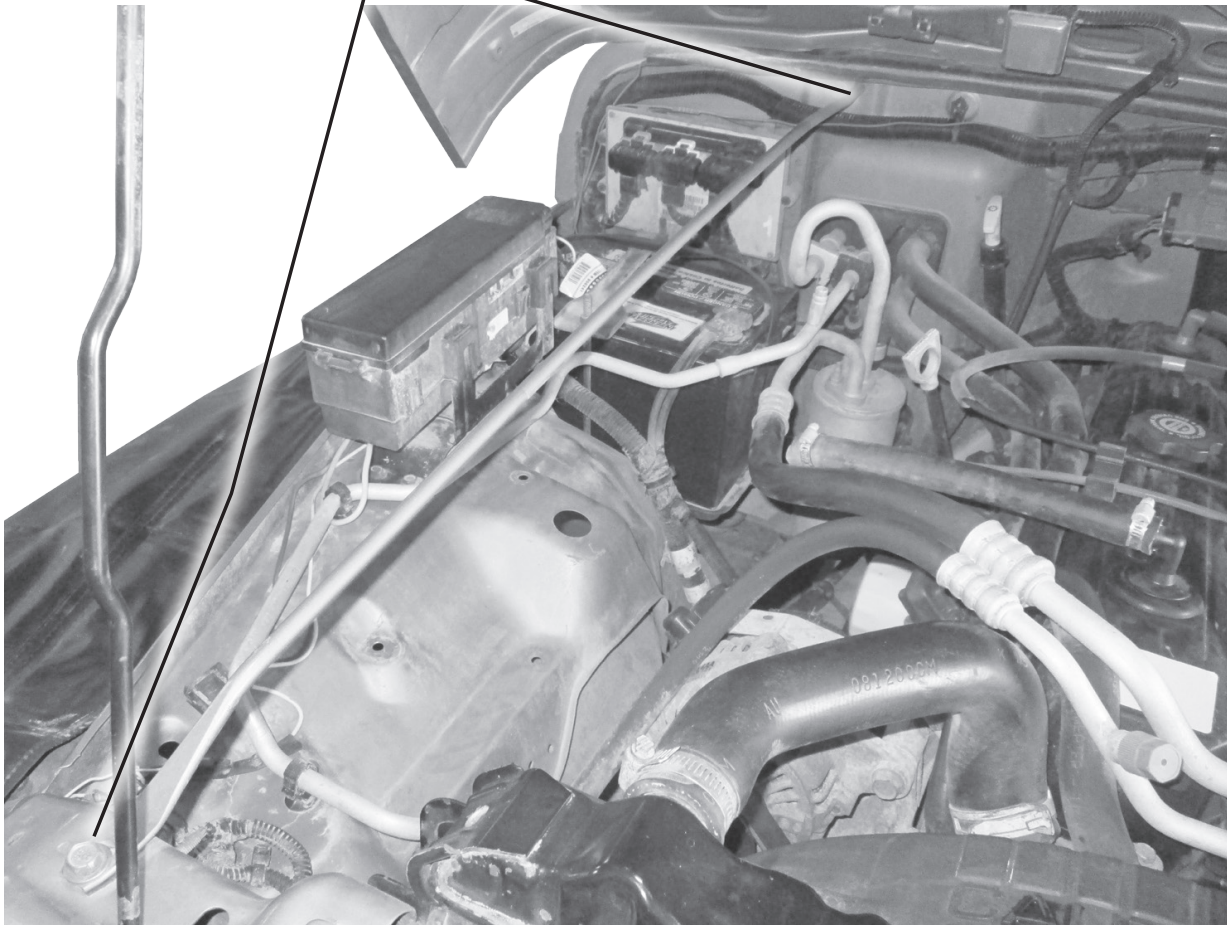

**STEP 9** - Using a 10mm socket and ratchet, remove the upper radiator bracket screw and set aside for later use.

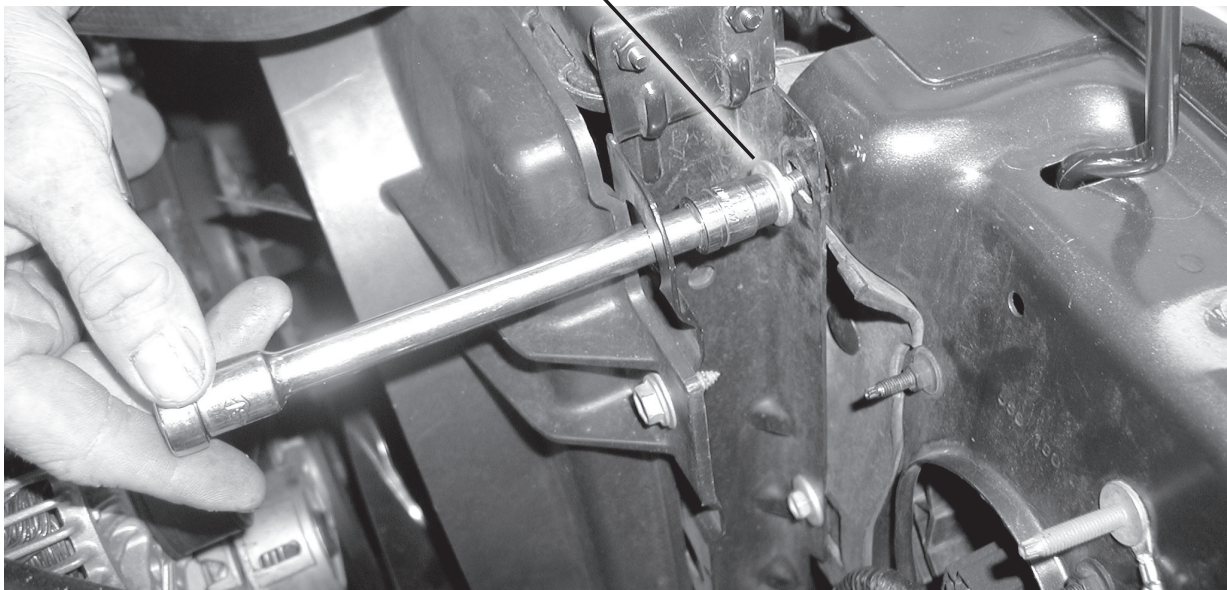

---

## INSTALLING THE HOUSING

---

**STEP 10** - Install the trim seal onto the housing.

**STEP 11** - Install the aFe housing using the supplied screws, washers and nuts. Reinstall the radiator bracket screw that was removed earlier to support the front of the housing.

**STEP 12** - Slide the grommet over the strut rod, then slide the strut rod through the opening in the housing. Press grommet into hole.

**STEP 13** - Secure the strut rod with the screws removed earlier.

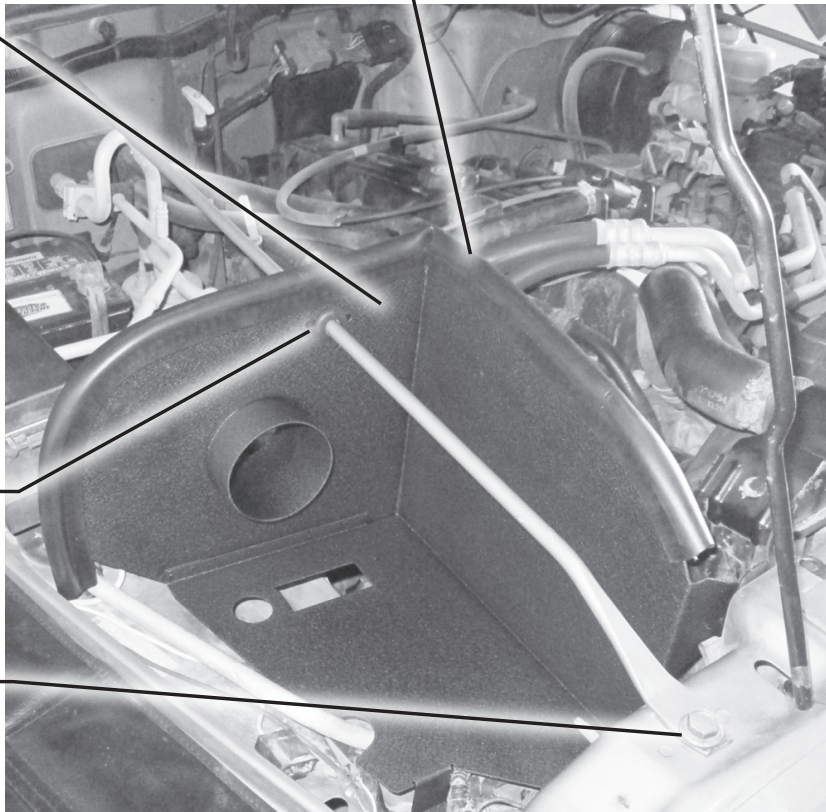

---

## INSTALLING THE INTAKE TUBE

---

**STEP 14** - Install the straight coupler and two #048 clamps onto the throttle body as shown.

**STEP 15** - Install the hump coupler and two #052 clamps on the filter housing.

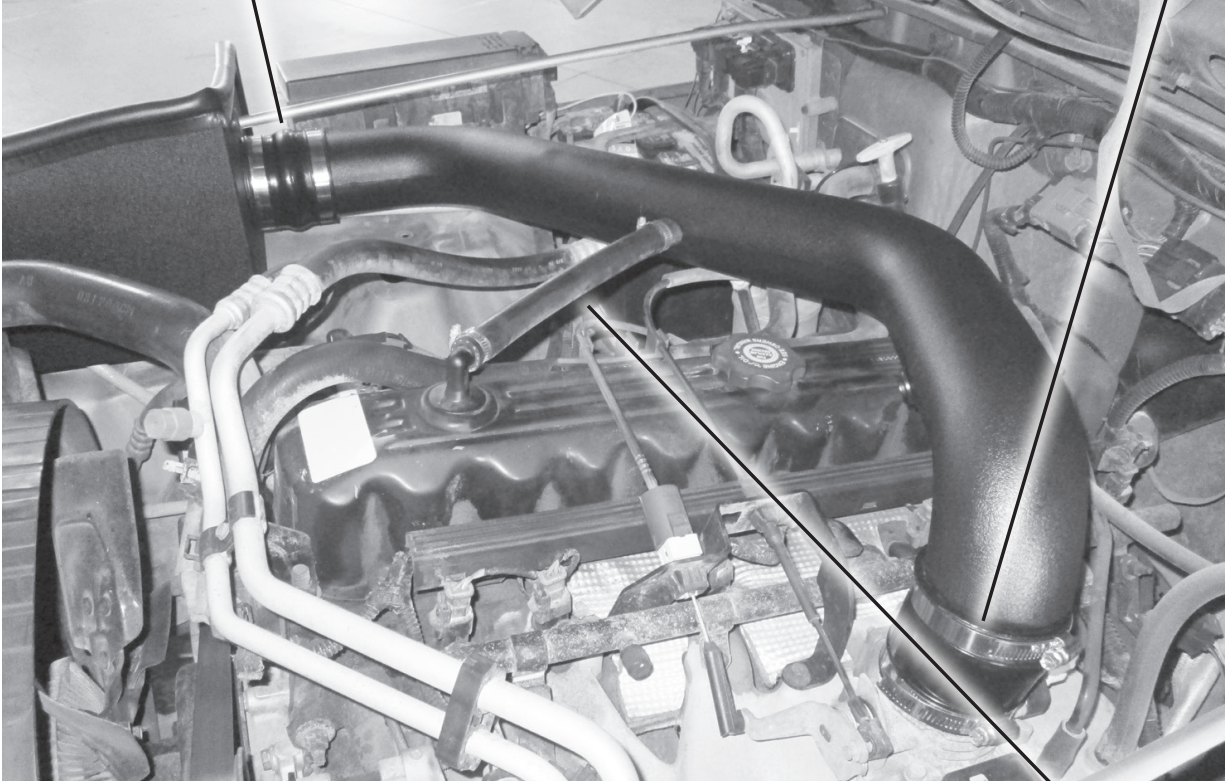

**STEP 16** - Install the intake tube into the couplers, align the tube then tighten coupler clamps.

**STEP 17** - Replace the vent hose with the supplied hose and mini clamps. Trim to length if necessary.



---

## INSTALLING THE FILTER

---

**STEP 18** - Install the filter and clamp. Tighten the filter clamp.

**STEP 19** - If equipped with an air temperature, remove the cap on the intake tube.



**STEP 20** - Remove the temperature sensor from the OE tube and insert it into the grommet on the intake tube and connect the harness to the sensor.

**STEP 21** - Make sure all clamps and connections are secured. Your installation is now completed.

*NOTE: Check all bolts, clamps and connectors after 200 miles.*

# WARRANTY

---

Powerteq, LLC, (hereafter “SELLER”), subject to the conditions and limitations set forth herein, warrants to the original consumer purchaser only that each Jammer product sold by SELLER (the “Product”) through an authorized dealer will be free from defects in material and workmanship under normal operating conditions for one (1) year after the date of purchase. SELLER will repair or replace, at SELLER’s option, any Product that is found to be defective in material or workmanship under normal operating conditions during the one-year period after the date of purchase by the original consumer purchaser.

## **What Is Not Covered by This Warranty?**

This warranty does not apply to any of the following:

1. Loss, damage, repairs, or maintenance required as a result of accident, abuse, negligence, or misuse.
2. Loss, damage, repairs, or maintenance required as a result of any third-party tuning software.
3. Loss, damage, repairs, or maintenance required as a result of fire, water, hail, theft, earthquake, wind, ice, lightening, acts of god, accident, animals, corrosive atmosphere, or other external causes beyond the control of SELLER.
4. Any special, indirect, incidental, consequential, or punitive damages, including property damage, arising out of or related to the use or loss of use of the Product under this Limited Warranty.
5. Any Products purchased through auction websites.

## **Limitation of Liability**

The terms of this Limited Warranty constitute the entire agreement between the parties with respect to the Product. The original consumer purchaser’s exclusive remedy shall be limited to the repair or replacement of the defective product. EXCLUDING THE LIMITED WARRANTY PROVIDED ABOVE, SELLER, TO THE MAXIMUM EXTENT PERMITTED BY LAW, MAKES NO WARRANTIES, EXPRESSED OR IMPLIED, AND DISCLAIMS ALL WARRANTIES, DUEITES AND CONDITIONS, WHETHER EXPRESS, IMPLIED, OR STATUTORY, WITH RESPECT TO THE WORK, INCLUDING WITHOUT LIMITATION ANY IMPLIED WARRANTIES OF MERCHANTABILITY OR FITNESS FOR A PARTICULAR PURPOSE. ANY REMEDY IS LIMITED TO THE PURCHASE PRICE OF THE PRODUCT.

---

### **How to Make a Warranty Claim**

Contact Powerteq Customer Service. BUYER will be required to submit proof of purchase from an authorized dealer within 5 days of the warranty claim.

THE INSTALLATION OF THIS PRODUCT INDICATES THAT THE BUYER HAS READ AND UNDERSTANDS THIS AGREEMENT AND ACCEPTS ITS TERMS AND CONDITIONS. IN THE EVENT THAT THE BUYER DOES NOT AGREE WITH THIS AGREEMENT, THE BUYER MAY PROMPTLY RETURN THIS PRODUCT, IN A NEW AND UNUSED CONDITION, WITH A DATED PROOF OF PURCHASE, TO THE PLACE OF PURCHASE WITHIN THIRTY (30) DAYS FROM DATE OF PURCHASE FOR A FULL REFUND.

**COPYRIGHT© 2017 REV 00**

*For additional questions not found in the user guide call:*

**Powerteq Technical Support: (855) 292-2121 6:00 am - 5:00 pm MST**

**To expedite your support call, please have your Vehicle Information,  
Part Number, and Serial Number ready prior to calling Technical Support.**